

CITY OF GARDNER, MA MAKI PARK PROJECT 57 PARKER STREET

ISSUED FOR BIDDING MAY 2023

LIST OF DRAWINGS		
SHEET NO.	DRAWING NO.	DRAWING TITLE
1	G-000	COVER
2	G-001	GENERAL NOTES, LEGEND & ABBREVIATIONS
3	C-101	EXISTING CONDITIONS AND DEMOLITION PLAN
4	C-201	SITE LAYOUT PLAN
5	C-301	GRADING & DRAINAGE PLAN
6	C-401	SITE FURNISHING & LANDSCAPING PLAN
7	C-501	SITE DETAILS - 1
8	C-502	SITE DETAILS - 2
9	C-503	SITE DETAILS - 3
10	E-001	ELECTRICAL NOTES, LEGEND, & ABBREVIATIONS
11	E-100	ELECTRICAL PLAN
12	E-501	ELECTRICAL DETAILS - 1
13	E-502	ELECTRICAL DETAILS - 2

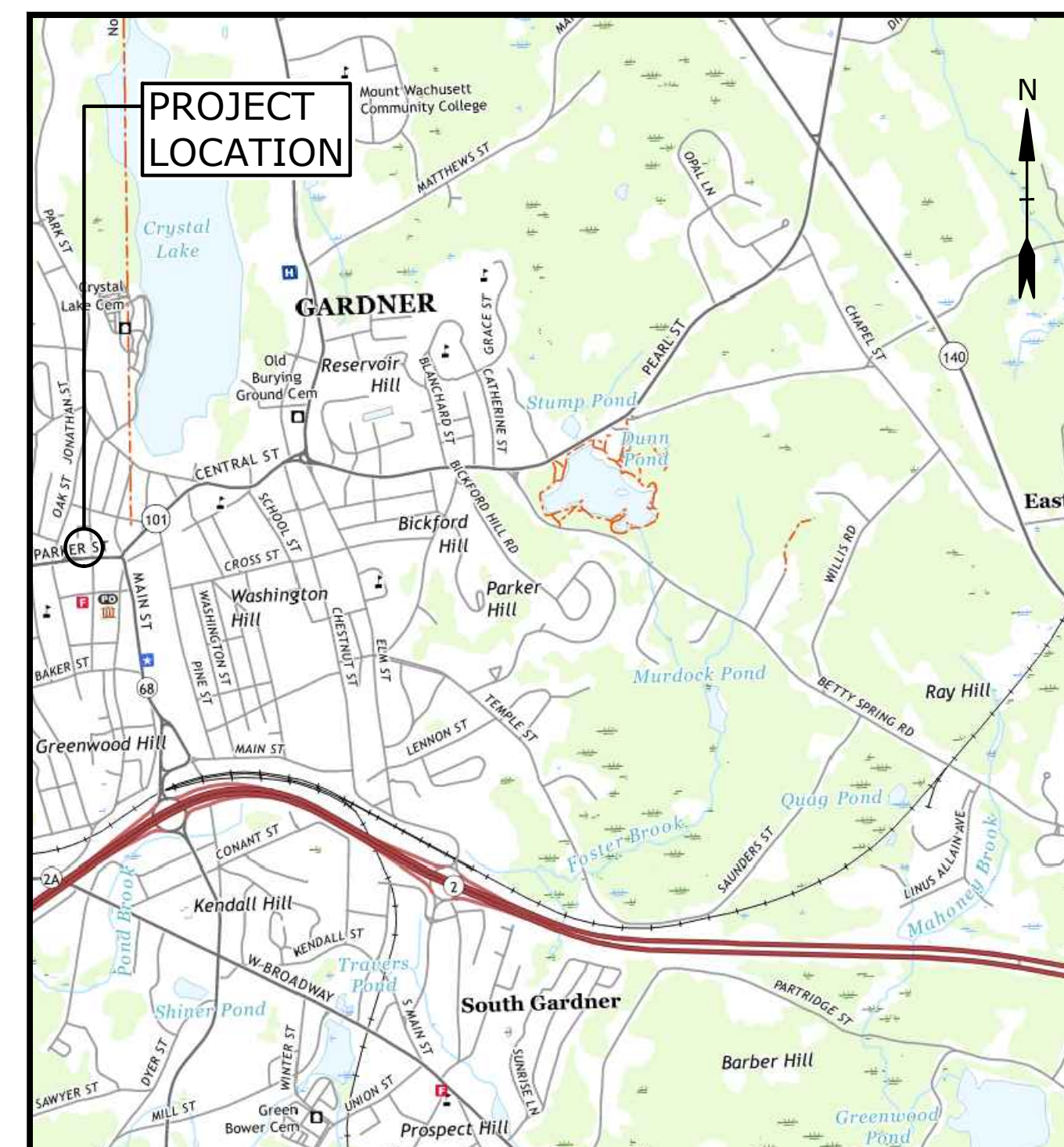

LOCATION MAP
SCALE: 1" = 2000'

PREPARED BY:

Tighe&Bond

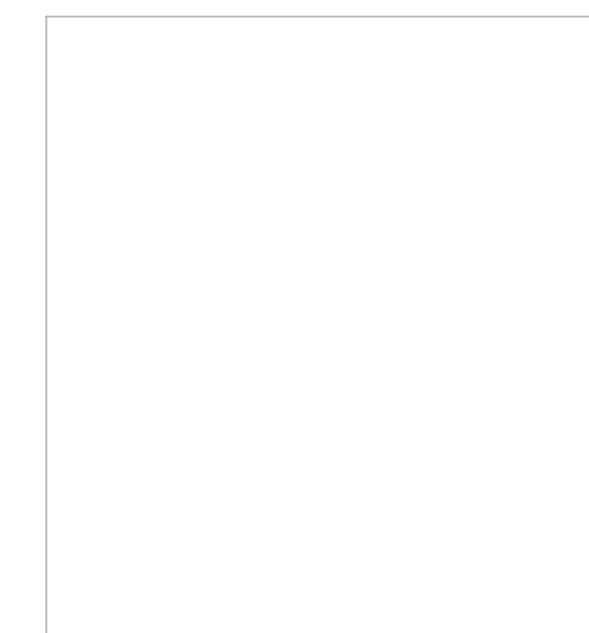

JOSEPH P. VIAMARI, JR., PE

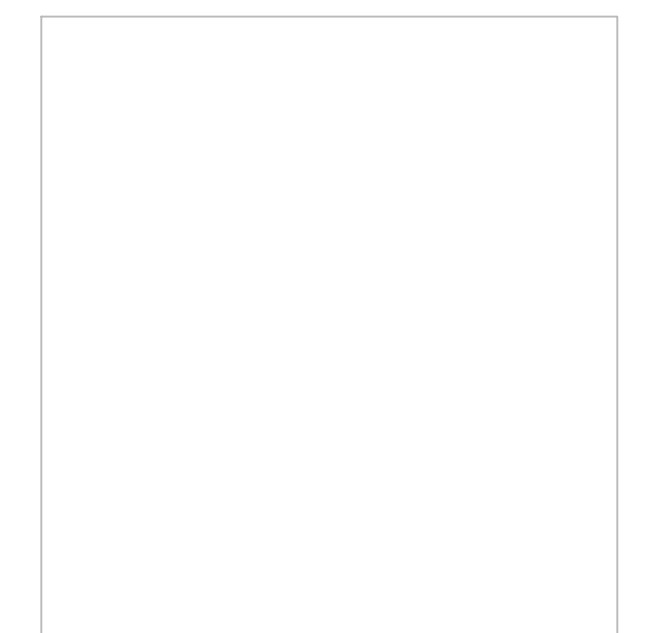

MATTHEW P. WZOREK, PE

PREPARED FOR:

CITY OF GARDNER, MA
DEPT. OF COMMUNITY DEVELOPMENT AND PLANNING
CITY HALL ANNEX - ROOM 21
115 PLEASANT ST
GARDNER, MA 01440

COMPLETE SET 13 SHEETS

LEGEND

DESCRIPTION	EXISTING	PROPOSED
PROPERTY LINE	-----	-----
RIGHT-OF-WAY LINE	-----	-----
EASEMENT LINE	-----	-----
LIMITS OF WORK	-----	-----
INTERMEDIATE CONTOURS	----- 21 -----	----- 21 -----
INDEX CONTOURS	----- 25 -----	----- 25 -----
SPOT GRADE	+ 141.2	+ 32.0
MAGNITUDE & DIRECTION OF SLOPE	← 0.0%	← 0.0%
STORM DRAIN	SD SD	SD UD
STORM UNDERDRAIN	-----	-----
GRAVITY SANITARY SEWER	SS SS	-----
SANITARY SEWER FORCE MAIN	SFM SFM	-----
SANITARY SEWER LOW PRESSURE	SSLP SSLP	-----
SANITARY SEWER COMBINED	COMB COMB	-----
WATER SERVICE	W W	-----
POTABLE WATER	PW PW	-----
FIRE SERVICE	-----	-----
HIGH PRESSURE FIRE SERVICE	-----	-----
UNDERGROUND ELECTRIC	E E	E E
PRIMARY ELECTRIC SERVICE	PE PE	-----
SECONDARY ELECTRIC	SE SE	-----
OVERHEAD ELECTRIC	OE OE	-----
TELEPHONE SERVICE	T T	-----
TEL-DATA SERVICE	T-D T-D	-----
COMMUNICATIONS SERVICE	T-C T-C	-----
CABLE TV SERVICE	CTV CTV	-----
GAS SERVICE	G G	-----
OVERHEAD UTILITY (UNSPECIFIED)	OHW OHW	-----
CURB	=====	=====
EDGE OF PAVEMENT	-----	-----
DIRT ROAD	-----	-----
SIDEWALK	-----	-----
RETAINING WALL	-----	-----
STONE WALL	-----	-----
FENCE - UNSPECIFIED	X X X	-----
FENCE - CHAIN LINK	X X X X X	-----
FENCE - WOOD POST	O O O O O	-----
GUARDRAIL	-----	-----
TIMBER GUIDERAIL	-----	-----
TRAIN TRACKS	-----	-----
STORM DRAIN STRUCTURES	MANHOLE (M) CATCH BASIN (CB)	-----
SANITARY SEWER MANHOLE	(S)	-----
WATER SERVICE STRUCTURES	HYDRANT (H) MANHOLE (M) VALVE (V)	-----
GAS SERVICE STRUCTURES	MANHOLE (G) VALVE (V)	-----
ELECTRIC SERVICE STRUCTURES	UTILITY CO. POLE (P) MANHOLE (M) LIGHT (L)	-----
TELECOMMUNICATIONS MANHOLE	(T)	-----
TREELINE	-----	-----
TREE	EVERGREEN (EG) DECIDUOUS (D)	EVERGREEN (EG) DECIDUOUS (D)

LEGEND

DEMOLITION / GEOTECHNICAL	=====
EROSION & SEDIMENT CONTROL	=====
UTILITY TO BE ABANDONED	-----
UTILITY TO BE DEMOLISHED	-----
ITEM TO BE DEMOLISHED	-----

ABBREVIATIONS

BC	BITUMINOUS CURB
BIT	BITUMINOUS
BL	BASELINE
BLDG	BUILDING
BOC	BOTTOM OF CURB
BOT	BOTTOM
BS	BOTTOM OF STEP
BW	BOTTOM OF WALL
CB	CATCH BASIN
CEM	CEMENT
CI	CAST IRON PIPE
CL	CENTERLINE
CO	CLEAN OUT
CONC	CONCRETE
CPP	CORRUGATED POLYETHYLENE PIPE
CY	CUBIC YARD
DH	DRILL HOLE
DI	DUCTILE IRON PIPE
DIA	DIAMETER
DMH	DRAIN MANHOLE
E	EAST
EF	EACH FACE
EG	EXISTING GRADE
EL/ELEV	ELEVATION
ELEC	ELECTRIC
EMH	ELECTRIC MANHOLE
EOP	EDGE OF PAVEMENT
EW	EACH WAY
EXIST	EXISTING
FES	FLARED END SECTION
FM	FORCE MAIN
G	GAS
GG	GAS GATE
GRAN	GRANITE
HC	HANDICAP
HDPE	HIGH DENSITY POLYETHYLENE
HMA	HOT MIX ASPHALT
HYD	HYDRANT
IN	INCHES
INV	INVERT
IP	IRON PIN
L	LENGTH OF CURB
LP	LIGHT POLE
LT	LEFT
MAX	MAXIMUM
MH	MANHOLE
MIN	MINIMUM
MISC	MISCELLANEOUS
MON	MONUMENT
N	NORTH
NITC	NOT IN THIS CONTRACT
NTS	NOT TO SCALE
N/A	NOT APPLICABLE
N/F	NOW OR FORMERLY
OC	ON CENTER
OH	OVERHEAD
PC	POINT OF CURVATURE
PCC	POINT OF COMPOUND CURVATURE
PERF	PERFORATED
PI	POINT OF INTERSECTION
PRC	POINT OF REVERSE CURVATURE
PSF	POUNDS PER SQUARE FOOT
PSI	POUNDS PER SQUARE INCH
PT	POINT OF TANGENCY
PVC	POLYVINYLCHLORIDE
PVMT	PAVEMENT
R	RADIUS
RCP	REINFORCED CONCRETE PIPE
REV	REVISION
ROW	RIGHT OF WAY
RT	RIGHT
R&D	REMOVE AND DISPOSE
R&R	REMOVE AND RESET
R&S	REMOVE AND STACK
S	SOUTH
SAN	SANITARY
SCH	SCHEDULE
SF	SQUARE FOOT
SS	STAINLESS STEEL
STA	STATION
STRM	STORM
T	TANGENT LENGTH
TC	TOP OF CURB
TP	TEST PIT
TS	TOP OF STEP
TW	TOP OF WALL
TYP	TYPICAL
UP	UTILITY POLE
W	WATER
WG	WATER GATE
WV	WATER VALVE

BASE PLAN NOTES

1. THE EXISTING CONDITIONS INFORMATION SHOWN ON THE DRAWINGS IS BASED ON THE FOLLOWING:
 - SURVEY DRAWINGS PROVIDED BY WSP USA, INC., TITLED "EXISTING CONDITIONS PLAN - PHASE 4 AND MAKI PARK - GARDNER, MASSACHUSETTS," AND DATED SEPTEMBER 23, 2022.
2. UTILITY LOCATIONS SHOWN WERE PLOTTED FROM INFORMATION SUPPLIED BY RESPECTIVE UTILITY COMPANIES AND DATA OBTAINED FROM FIELD SURVEYS AND AS BUILT DRAWINGS. THE ACCURACY AND COMPLETENESS OF SUBSURFACE INFORMATION SHOWN ON THESE DRAWINGS IS NOT GUARANTEED. DETERMINE THE LOCATIONS AND ELEVATIONS OF ALL UTILITIES WHICH MAY AFFECT CONSTRUCTION OPERATIONS.
3. THE DRAWINGS ARE BASED ON THE FOLLOWING DATUMS: HORIZONTAL - NAD83; VERTICAL - NAVD88.
4. THE EXISTING CONDITIONS SHOWN ARE APPROXIMATE. FIELD VERIFY EXISTING CONDITIONS.
5. THE PROPERTY LINES SHOWN ON THE DRAWINGS ARE APPROXIMATE AND ARE NOT BASED ON DEED OR PLAN RESEARCH.

GENERAL NOTES

1. NOTIFY DIGSAFE AT 1-888-344-7233 AND OTHER UTILITY OWNERS IN THE AREA NOT ON THE DIGSAFE LIST AT LEAST 72 HOURS PRIOR TO ANY DIGGING, TRENCHING, ROCK REMOVAL, DEMOLITION, BORING, BACKFILLING, GRADING, LANDSCAPING, OR ANY OTHER EARTH MOVING OPERATIONS.
2. LOCATIONS OF EXISTING UTILITIES ARE APPROXIMATE. IN ADDITION, SOME UTILITIES MAY NOT BE SHOWN. DETERMINE THE EXACT LOCATION OF UTILITIES BY TEST PIT OR OTHER METHODS, AS NECESSARY TO PREVENT DAMAGE TO UTILITIES AND/OR INTERRUPTIONS IN UTILITY SERVICE. PERFORM TEST PIT EXCAVATIONS AND OTHER INVESTIGATIONS TO LOCATE UTILITIES, AND PROVIDE THIS INFORMATION TO THE ENGINEER, PRIOR TO CONSTRUCTING THE PROPOSED IMPROVEMENTS. LOCATE ALL EXISTING UTILITIES TO BE CROSSED BY HAND EXCAVATION.
3. NOT ALL OF THE UTILITY SERVICES TO BUILDINGS ARE SHOWN. THE CONTRACTOR SHALL ANTICIPATE THAT EACH PROPERTY HAS SERVICE CONNECTIONS FOR THE VARIOUS UTILITIES.
4. BOLD TEXT AND LINES INDICATE PROPOSED WORK. LIGHT TEXT AND LINES INDICATE APPROXIMATE EXISTING CONDITIONS.
5. TIGHE & BOND ASSUMES NO RESPONSIBILITY FOR ANY ISSUES, LEGAL OR OTHERWISE, RESULTING FROM CHANGES MADE TO THESE DRAWINGS WITHOUT WRITTEN AUTHORIZATION FROM TIGHE & BOND.
6. EXCAVATE ADDITIONAL TEST PITS TO LOCATE EXISTING UTILITIES AS DIRECTED OR APPROVED BY THE ENGINEER.
7. NOTIFY THE ENGINEER OF ANY UTILITIES IDENTIFIED DURING CONSTRUCTION THAT ARE NOT SHOWN ON THE DRAWINGS OR THAT DIFFER IN SIZE OR MATERIAL.
8. THE CONTRACTOR IS RESPONSIBLE FOR SITE SAFETY; COORDINATION WITH THE OWNER, ALL SUBCONTRACTORS, AND WITH OTHER CONTRACTORS WORKING WITHIN THE LIMITS OF WORK, THE MEANS AND METHODS OF CONSTRUCTING THE PROPOSED WORK.
9. OBTAIN, PAY FOR AND COMPLY WITH PERMITS, NOTICES AND FEES NECESSARY TO COMPLETE THE WORK. ARRANGE AND PAY FOR NECESSARY INSPECTIONS AND APPROVALS FROM THE JURISDICTIONAL AUTHORITIES.
10. SHORE UTILITY TRENCHES WHERE FIELD CONDITIONS DICTATE AND/OR WHERE REQUIRED BY LOCAL, STATE AND FEDERAL HEALTH AND SAFETY CODES.
11. FIELD VERIFY ALL EXISTING CONDITIONS PRIOR TO CONSTRUCTION. IF FIELD CONDITIONS ARE OBSERVED THAT VARY SIGNIFICANTLY FROM THOSE SHOWN ON THE DRAWINGS, IMMEDIATELY NOTIFY THE ENGINEER IN WRITING FOR RESOLUTION OF THE CONFLICTING INFORMATION.
12. PROTECT AND MAINTAIN ALL UTILITIES IN THE AREAS UNDER CONSTRUCTION DURING THE WORK. LEAVE ALL PIPES AND STRUCTURES WITHIN THE LIMITS OF THE CONTRACT IN A CLEAN AND OPERABLE CONDITION AT THE COMPLETION OF THE WORK. TAKE ALL NECESSARY PRECAUTIONS TO PREVENT SAND AND SILT FROM DISTURBED AREAS FROM ENTERING THE DRAINAGE SYSTEM.
13. NOTIFY THE ENGINEER IN WRITING OF ANY CONFLICT, ERROR, AMBIGUITY, OR DISCREPANCY WITH THE PLANS OR BETWEEN THE PLANS AND ANY APPLICABLE LAW, REGULATION, CODE, STANDARD SPECIFICATION, OR MANUFACTURER'S INSTRUCTIONS.
14. THE CONTRACTOR IS RESPONSIBLE FOR SUPPORT OF EXISTING UTILITIES AND REPAIR OR REPLACEMENT COSTS OF UTILITIES DAMAGED DURING CONSTRUCTION, WHETHER ABOVE OR BELOW GRADE. REPLACE DAMAGED UTILITIES IMMEDIATELY AT NO ADDITIONAL COST TO THE OWNER AND AT NO COST TO THE PROPERTY OWNER.
15. TAKE NECESSARY MEASURES AND PROVIDE CONTINUOUS BARRIERS OF SUFFICIENT TYPE, SIZE, AND STRENGTH TO PREVENT ACCESS TO ALL WORK AND STAGING AREAS AT THE COMPLETION OF EACH DAYS WORK.
16. NO OPEN TRENCHES WILL BE ALLOWED OVER NIGHT. THE USE OF ROAD PLATES TO PROTECT THE EXCAVATION WILL BE CONSIDERED UPON REQUEST, BUT BACKFILLING IS PREFERRED.
17. THE CONTRACTOR IS RESPONSIBLE FOR ALL NECESSARY TRAFFIC CONTROL/SAFETY DEVICES TO ENSURE SAFE VEHICULAR AND PEDESTRIAN ACCESS THROUGH THE WORK AREA, OR FOR SAFELY IMPLEMENTING DETOURS AROUND THE WORK AREA. PERFORM TRAFFIC CONTROL IN ACCORDANCE WITH THE CONTRACTOR'S APPROVED TRAFFIC CONTROL PLAN.
18. MAINTAIN EMERGENCY ACCESS TO ALL PROPERTIES WITHIN THE PROJECT AREA AT ALL TIMES DURING CONSTRUCTION.
19. WHEN WORKING IN THE ROAD, PROVIDE THE OWNER AND LOCAL FIRE/POLICE/SCHOOL AUTHORITIES A DETAILED PLAN OF APPROACH INDICATING METHODS OF PROPOSED TRAFFIC ROUTING ON A DAILY BASIS. PROVIDE COORDINATION TO ENSURE COMMUNICATION AND COORDINATION BETWEEN THE OWNER, CONTRACTOR AND LOCAL FIRE/POLICE/SCHOOL AUTHORITIES THROUGHOUT THE CONSTRUCTION PERIOD.
20. REMOVE AND DISPOSE OF ALL CONSTRUCTION-RELATED WASTE MATERIALS AND DEBRIS IN STRICT ACCORDANCE WITH ALL APPLICABLE LOCAL, STATE, AND FEDERAL LAWS.
21. THE TERM "DEMOLISH" USED ON THE DRAWINGS MEANS TO REMOVE AND DISPOSE OF IN ACCORDANCE WITH LOCAL, STATE, AND FEDERAL REQUIREMENTS.
22. THE TERM "ABANDON" USED ON THE DRAWINGS MEANS TO LEAVE IN PLACE AND TAKE APPROPRIATE MEASURES TO DECOMMISSION AS SPECIFIED OR NOTED ON THE DRAWINGS.
23. ALL PROPOSED WORK MAY BE ADJUSTED IN THE FIELD BY THE OWNER'S PROJECT REPRESENTATIVE TO MEET EXISTING CONDITIONS.

ISSUED FOR BIDDING

Maki Park Project

Department of
Community
Development
and Planning

Gardner, MA

0	5/2/2023	ISSUED FOR BIDDING
MARK	DATE	DESCRIPTION
PROJECT NO:		G0384-80
DATE:		05/2023
FILE: G0384-80 G-000-COV-NOTES.dwg		
DRAWN BY:		JDG
CHECKED BY:		MPW
APPROVED BY:		JPV

GENERAL NOTES, LEGEND & ABBREVIATIONS

SCALE: NO SCALE

G-001
SHEET 2 OF 13

EXISTING CONDITIONS NOTES

1. SEE BASE MAP NOTES AND GENERAL NOTES ON SHEET G-001.

EROSION CONTROL AND RESOURCE AREA PROTECTION NOTES

1. PROVIDE ALL EROSION CONTROL MEASURES SHOWN, SPECIFIED, REQUIRED BY PERMIT, AND/OR REQUIRED BY THE ENGINEER PRIOR TO ANY CONSTRUCTION OR IMMEDIATELY UPON REQUEST. MAINTAIN SUCH CONTROL MEASURES UNTIL FINAL SURFACE TREATMENTS ARE IN PLACE AND/OR UNTIL PERMANENT VEGETATION IS ESTABLISHED. INSPECT AFTER EACH RAINSTORM AND DURING MAJOR STORM EVENTS TO CONFIRM THAT ALL SEDIMENTATION AND EROSION CONTROL MEASURES REQUIRED ARE IN PLACE AND EFFECTIVE.
2. INSTALL SILT SACKS OR OTHER APPROVED SEDIMENTATION BARRIERS IN/AT ALL CATCH BASINS IN THE PROJECT AREA.
3. COMPACT, STABILIZE, AND LOAM AND SEED SIDE SLOPES, SHOULDER AREAS AND DISTURBED VEGETATED AREAS IN ACCORDANCE WITH THE CONTRACT DOCUMENTS AND AS REQUIRED BY PERMITS. GRADE SIDE SLOPES, SHOULDER AREAS AND DISTURBED VEGETATED AREAS TO A MAXIMUM SLOPE OF 3 HORIZONTAL TO 1 VERTICAL (3H:1V), WHERE POSSIBLE. PROVIDE BIODEGRADABLE EROSION CONTROL BLANKETS TO PREVENT EROSION WHERE SLOPES ARE STEEPER THAN 3H:1V.
4. SETTLE OR FILTER ALL SILT-LADEN WATER FROM DEWATERING ACTIVITIES IN A SEDIMENTATION OR FILTER BAG TO REMOVE SEDIMENTS PRIOR TO RELEASE USING A SEDIMENTATION OR FILTER BAG LOCATED DOWN-GRADIENT OF THE DEWATERED AREA.
5. REMOVE AND PROPERLY DISPOSE OF SILT TRAPPED AT BARRIERS IN UPLAND AREAS OUTSIDE BUFFER ZONES. REMOVE MATERIALS DEPOSITED IN ANY TEMPORARY SETTLING BASINS AT THE COMPLETION OF THE PROJECT. RESTORE ALL DISTURBED AREAS TO THEIR PRECONSTRUCTION CONDITION.
6. SWEEP, COLLECT, REMOVE AND DISPOSE OF ANY SEDIMENT TRACKED ONTO PUBLIC RIGHT-OF-WAYS AT THE END OF EACH DAY.
7. LOAM AND SEED ALL DISTURBED VEGETATED AREAS TO ESTABLISH COVER AND STABILIZATION AS SOON AS POSSIBLE FOLLOWING DISTURBANCE.
8. MAINTAIN AN ADDITIONAL SUPPLY OF EROSION CONTROL MEASURES ON-SITE FOR EMERGENCY REPAIRS.
9. STORE FUEL, OIL, PAINT, OR OTHER HAZARDOUS MATERIALS IN A SECONDARY CONTAINER AND REMOVE TO A SECURE LOCKED AND COVERED AREA DURING NON-WORK HOURS.
10. PROVIDE A SUPPLY OF ABSORBENT SPILL RESPONSE MATERIALS SUCH AS BOOMS, BLANKETS, AND OIL ABSORBENT MATERIALS AT THE CONSTRUCTION SITE AT ALL TIMES TO CLEAN UP POTENTIAL SPILLS OF HAZARDOUS MATERIALS. IMMEDIATELY REPORT SPILLS OF HAZARDOUS MATERIALS TO THE STATE ENVIRONMENTAL AGENCY AND THE MUNICIPALITY WHERE THE WORK IS OCCURRING.

PID: M22-5-8
20 GRAHAM ST
N/F QUEST MANAGEMENT GROUP LLC
BOOK/PAGE: 66416/176

PID: M22-5-10
GRAHAM ST
N/F CITY OF GARDNER
BOOK/PAGE: 7581/37

PID: M22-5-7
57-67 PARKER ST
N/F CITY OF GARDNER
BOOK/PAGE: 56734/0254

BENCHMARK:
BMK-B X-CUT BOMO
ELEV: 1084.39'

PID: M22-5-11
ON PARKER ST
N/F CITY OF GARDNER
BOOK/PAGE: 8434/0283

CB
RIM=1080.06
DEPTH=1075.46
WATER LEVEL=1076.76
INV.1=1076.76
INV.2=UTO

CB
RIM=1078.54
DEPTH=1074.54
INV.1=1076.04
INV.2=1075.94
INV.3=1075.84
INV.4=1073.84

CB
RIM=1074.89
INV.1=1072.09
INV.2=1071.49

CB
RIM=1080.45
DEPTH=1074.15
INV.1=1077.05
INV.2=1076.85
FULL OF WATER

PID: M22-4-70
WEST STREET LOT
N/F CITY OF GARDNER
BOOK/PAGE: NO REF.

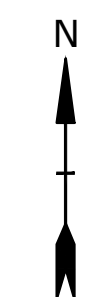

ISSUED FOR BIDDING

Maki Park Project

Department of
Community
Development
and Planning

Gardner, MA

0	5/2/2023	ISSUED FOR BIDDING
MARK	DATE	DESCRIPTION
PROJECT NO:	G0384-80	
DATE:	05/2023	
FILE:	G0384-80 C-X00-PLANS.dwg	
DRAWN BY:	JDG	
CHECKED BY:	MPW	
APPROVED BY:	JPV	

EXISTING CONDITIONS
AND DEMOLITION PLAN

SCALE: 1" = 10'

C-101
SHEET 3 OF 13

Last Saved: 5/2/2023 1:28pm By: ABS
 Plotted On: May 02, 2023 1:28pm
 Tighe & Bond | 1150 Gardner St | Gardner, MA 01854 | Phone: 978-686-1100 | Fax: 978-686-1101 | Email: info@tigheandbond.com

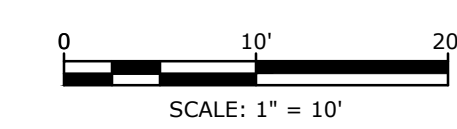
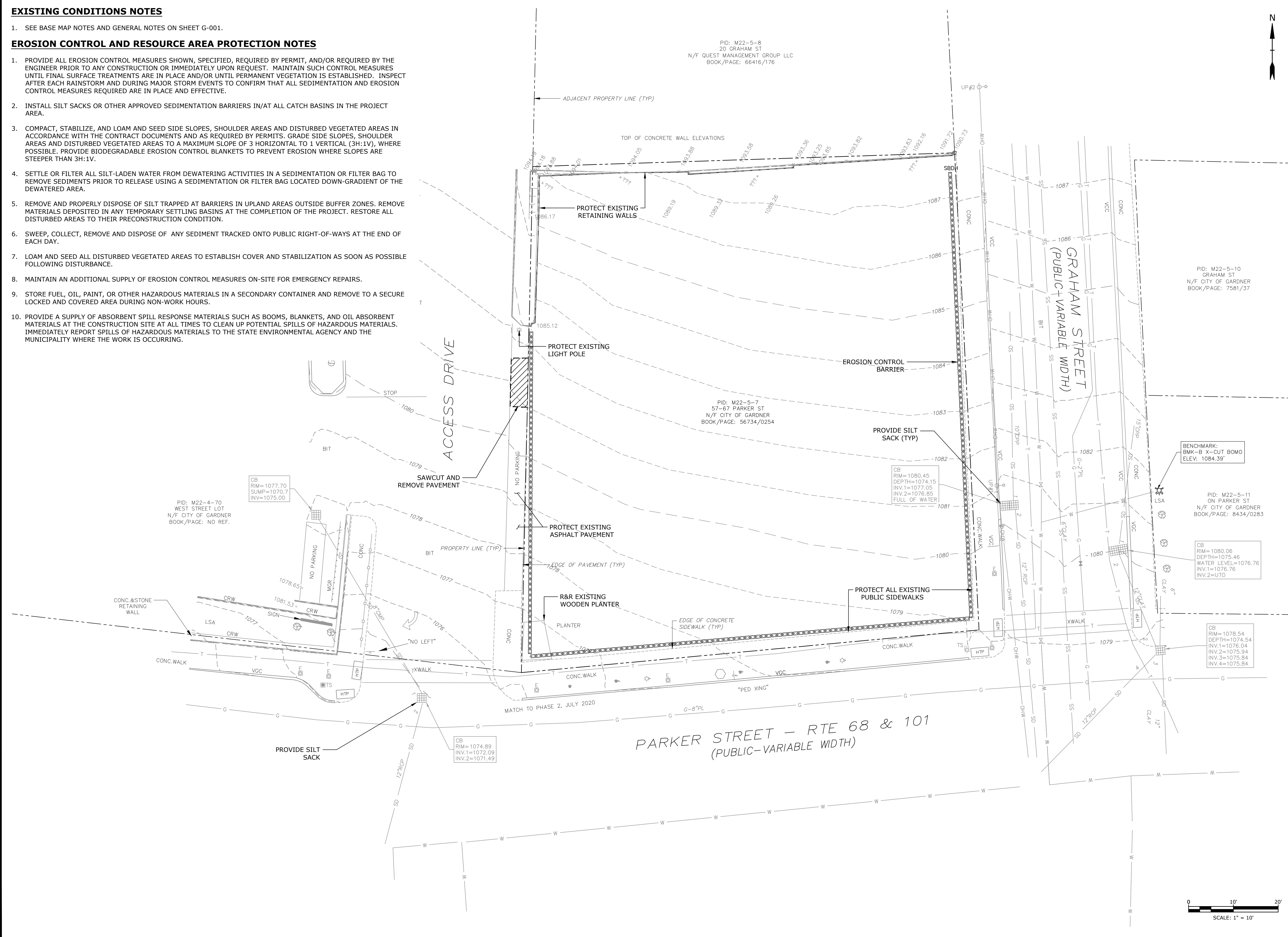

SURFACE RESTORATION NOTES

1. ALL PAVEMENT DAMAGED BY THE CONTRACTOR'S OPERATIONS SHALL BE REPLACED IN ACCORDANCE WITH THE CONTRACT DOCUMENTS.
2. PROVIDE SITE GRADING AT HANDICAPPED RAMPS, SIDEWALKS, AND BUILDING ENTRANCES THAT IS CONSISTENT WITH THE RELEVANT ACCESS REQUIREMENTS OF THE ARCHITECTURAL BARRIERS ACT (ABA), THE AMERICANS WITH DISABILITIES ACT (ADA), AND MA ARCHITECTURAL ACCESS BOARD REQUIREMENTS (AAB). SMALL CHANGES IN GRADE OVER RELATIVELY SHORT DISTANCES (E.G. AT PARKING SPACES, ACCESSIBLE ROUTES, AND RAMPS) MIGHT NOT BE CLEARLY DEPICTED WITHIN THE CONTOUR INTERVAL SHOWN. COMPLY WITH THE CRITERIA IN THESE STANDARDS. SELECT MAXIMUM SLOPE CRITERIA ARE REPRODUCED BELOW:
 - ACCESSIBLE PARKING STALL AND PASSENGER LOADING ZONE (ANY DIRECTION) SLOPE < 2.0%
 - LONGITUDINAL SLOPE ALONG ACCESSIBLE ROUTES < 5.0%
 - CROSS SLOPE ALONG ACCESSIBLE ROUTES < 2.0%
3. PROTECT PROJECT FEATURES (E.G., WALLS, FENCES, MAIL BOXES, SIGNS, SIDEWALKS, CURBING, STAIRS, WALKWAYS, TREES, ETC.) FROM DAMAGE DURING CONSTRUCTION, INCLUDING PROVIDING TEMPORARY SUPPORTS, WHEN APPROPRIATE.
4. IF REMOVAL OF PROJECT FEATURES IS REQUIRED IN ORDER TO PERFORM THE PROPOSED WORK, REMOVE THOSE SITE FEATURES ONLY UPON APPROVAL OF ENGINEER. REPLACE ALL REMOVED PROJECT FEATURES; NEW ITEMS SHALL BE EQUAL OR BETTER IN QUALITY AND CONDITION TO THE ITEMS REMOVED.
5. EXISTING SURVEY MONUMENTS DISTURBED BY THE CONTRACTOR SHALL BE REPLACED BY A LAND SURVEYOR LICENSED IN THE STATE IN WHICH THE WORK IS PERFORMED AT NO ADDITIONAL COST TO THE OWNER.
6. COORDINATE THE ADJUSTMENT OF EXISTING UTILITY STRUCTURES WITH EACH RESPONSIBLE UTILITY OWNER PRIOR TO RECONSTRUCTION AND/OR PAVING OPERATIONS. RAISE ALL STRUCTURES TO FINISHED GRADES PRIOR TO THE END OF THE CONSTRUCTION SEASON AND PRIOR TO FINISHED PAVING.
7. REPAIR DISTURBED PAVED SURFACES AT THE END OF EACH WORK WEEK, UNLESS OTHERWISE APPROVED/REQUIRED BY THE OWNER.
8. PLACE TEMPORARY BITUMINOUS CONCRETE PAVEMENT AT DISTURBED PORTLAND CEMENT CONCRETE SIDEWALKS AND DRIVEWAYS AT THE END OF EACH WORK WEEK, UNLESS OTHERWISE APPROVED/REQUIRED BY THE OWNER.
9. TRANSFER ALL TEMPORARY BENCHMARKS, AS NECESSARY.
10. ACCOMMODATE PEDESTRIAN TRAFFIC WHERE A SIDEWALK IS TO BE CLOSED FOR SAFETY. "SIDEWALK CLOSED HERE" SIGNS SHALL BE USED AT THE NEAREST SAFE INTERSECTION. SEE TRAFFIC CONTROL DETAILS FOR SIGN INFORMATION.
11. RESTORE ALL AREAS DISTURBED BY THE CONTRACTOR BEYOND THE PAYLINE LIMITS TO ORIGINAL CONDITIONS AT NO ADDITIONAL COST TO THE OWNER.
12. REGRADE ALL UNPAVED AREAS DISTURBED BY THE WORK AS REQUIRED. REPAIR/REPLACE PAVED SURFACES DISTURBED BY THE WORK IN-KIND, UNLESS OTHERWISE NOTED. RESTORE SURFACES TO EXISTING OR PROPOSED CONDITIONS AS INDICATED ON THE DRAWINGS.
13. PROVIDE A SMOOTH, FLUSH TRANSITION BETWEEN ALL NEW AND EXISTING PAVEMENTS AND WALKING SURFACES.

PID: M22-5-8
20 GRAHAM ST
N/F QUEST MANAGEMENT GROUP LLC
BOOK/PAGE: 66416/176

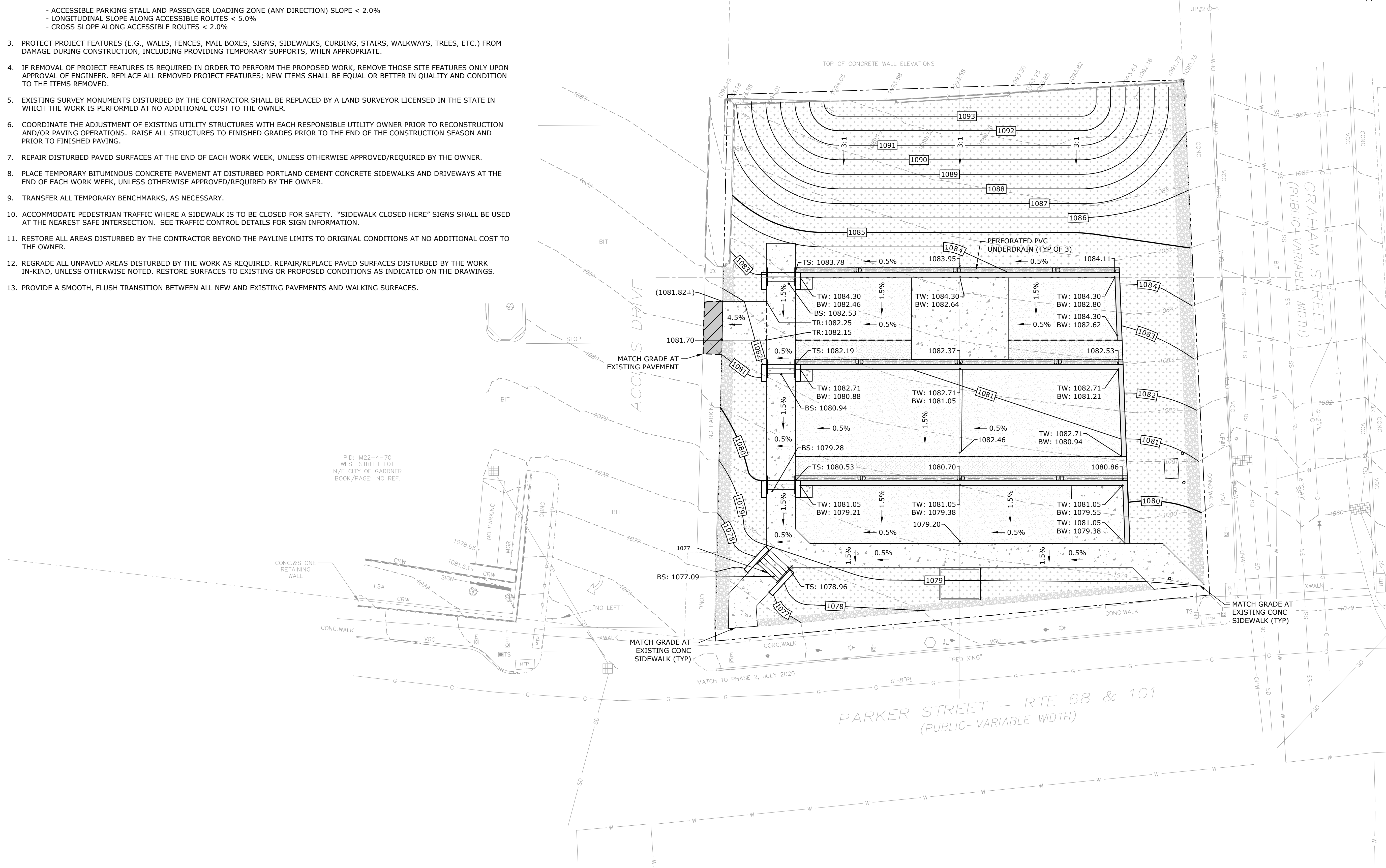

Maki Park Project

Department of
Community
Development
and Planning

Gardner, MA

0	5/2/2023	ISSUED FOR BIDDING
MARK	DATE	DESCRIPTION
PROJECT NO:	G0384-80	
DATE:	05/2023	
FILE:	G0384-80 C-X00-PLANS.dwg	
DRAWN BY:	JDG	
CHECKED BY:	MPW	
APPROVED BY:	JPV	

GRADING & DRAINAGE PLAN

SCALE: 1" = 10'

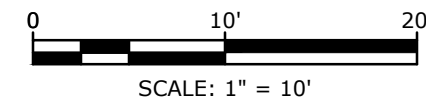

C-301
SHEET 5 OF 13

Last Saved: 5/2/2023 1:29pm By: ABS
 Plotted On: May 02, 2023 1:29pm
 Tighe & Bond | 110 Gardner Street | Gardner, MA 01840 | Phone: 978-686-1100 | Fax: 978-686-1101 | Email: info@tigheandbond.com

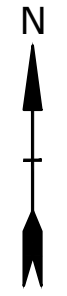

PID: M22-5-8
20 GRAHAM ST
N/F QUEST MANAGEMENT GROUP LLC
BOOK/PAGE: 66416/176

PLANTING SCHEDULE						
TAG	QTY	BOTANICAL NAME	COMMON NAME	SIZE	SPACING	NOTES
TREES						
AC RU	7	ACER RUBRUM 'OCTOBER GLORY'	'OCTOBER GLORY' RED MAPLE	3.5-4" CAL	SEE PLAN	B&B; MATCHED
SHRUBS						
Ju Ho	3	JUNIPERUS HORIZONTALIS 'WILTONII'	BLUE RUG JUNIPER	#3 CONTAINER	72" O.C.	
Vi Ac	22	VIBURNUM ACERIFOLIUM	MAPLE LEAF VIBURNUM	#3 CONTAINER	48" O.C.	
PERENNIALS & GROUND COVER						
ar uv	48	ARCTOSTAPHYLOS UVA-URSI	BEARBERRY	#1 CONTAINER	24" O.C.	

SITE FURNISHING SCHEDULE			
TAG	QTY	ITEM	NOTES
A	3	ROUND PICNIC TABLE	OWNER FURNISHED
AA	1	ACCESSIBLE ROUND PICNIC TABLE	OWNER FURNISHED
B	3	WASTE RECEPTACLE	
C	1	PET WASTE STATION	SEE DETAIL SHEET C-502
D	2	ROUND CHECKERBOARD TABLE SET	
E	4	CONCRETE CORNHOLE BOARD W/ BAG THROWER AREA BLOCKS	
F	4	SINGLE LOOP BIKE RACK	SEE DETAIL SHEET C-503
G	245 LF	THREE RAIL WOOD FENCE	SEE DETAIL SHEET C-502

SITE FURNISHING NOTES:

- ALL SITE FURNISHINGS TO BE INSTALLED ACCORDING TO MANUFACTURER'S SPECIFICATIONS.

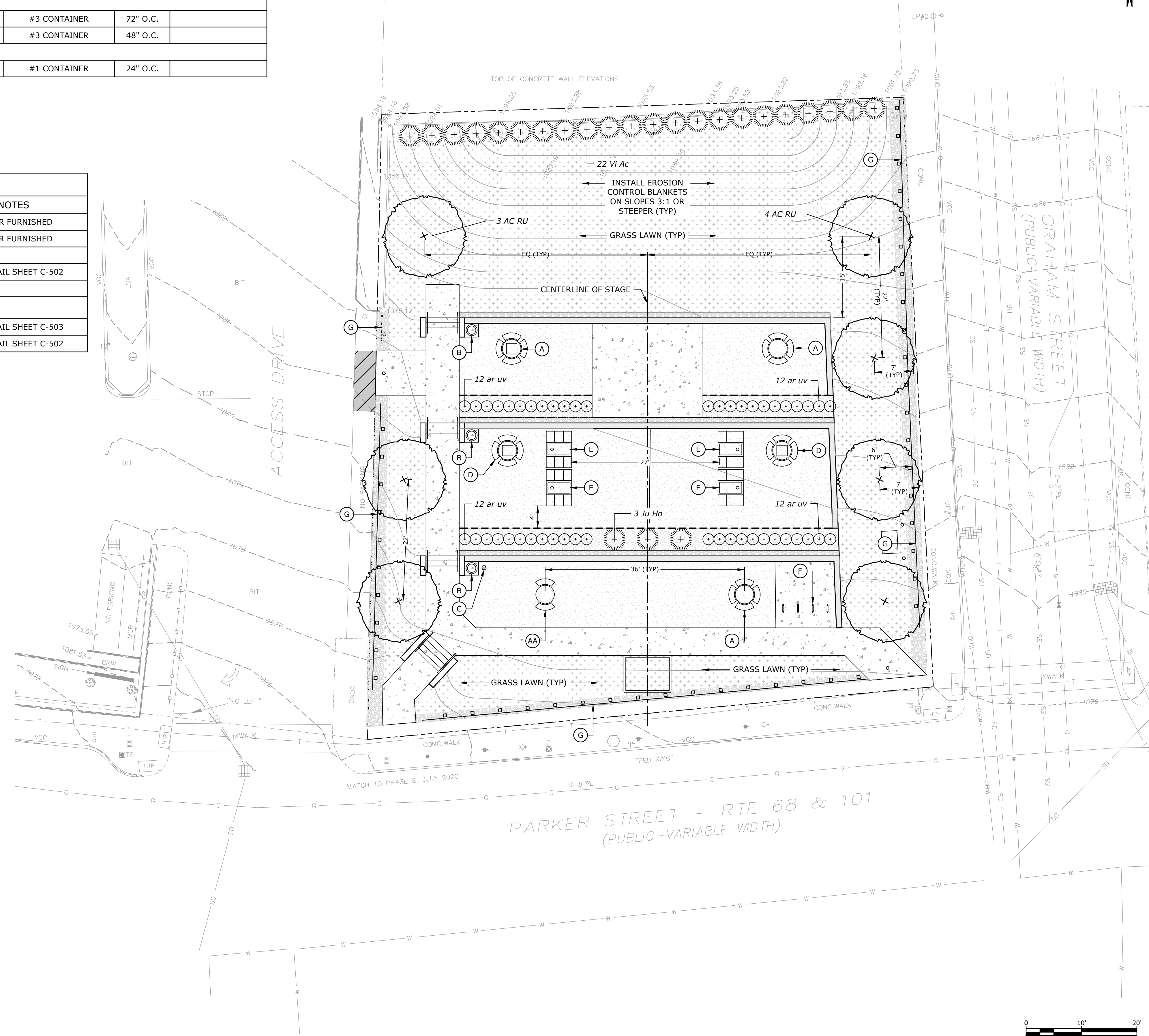

ISSUED FOR BIDDING

Maki Park Project

Department of
Community
Development
and Planning

Gardner, MA

0	5/2/2023	ISSUED FOR BIDDING
MARK	DATE	DESCRIPTION
PROJECT NO:	G0384-80	
DATE:	05/2023	
FILE:	G0384-80 C-X00-PLANS.dwg	
DRAWN BY:	JDG	
CHECKED BY:	MPW	
APPROVED BY:	JPV	

SITE FURNISHING & LANDSCAPING PLAN		
SCALE:	1" = 10'	

C-401
SHEET 6 OF 13

Last Saved: 5/2/2023 11:29pm By: ABS
Plotted On: May 02, 2023 1:15pm By: Tighe & Bond
C:\Users\abs\AppData\Local\Temp\AutoCAD\Sheet\G0384-80 C-X00-PLANS.dwg

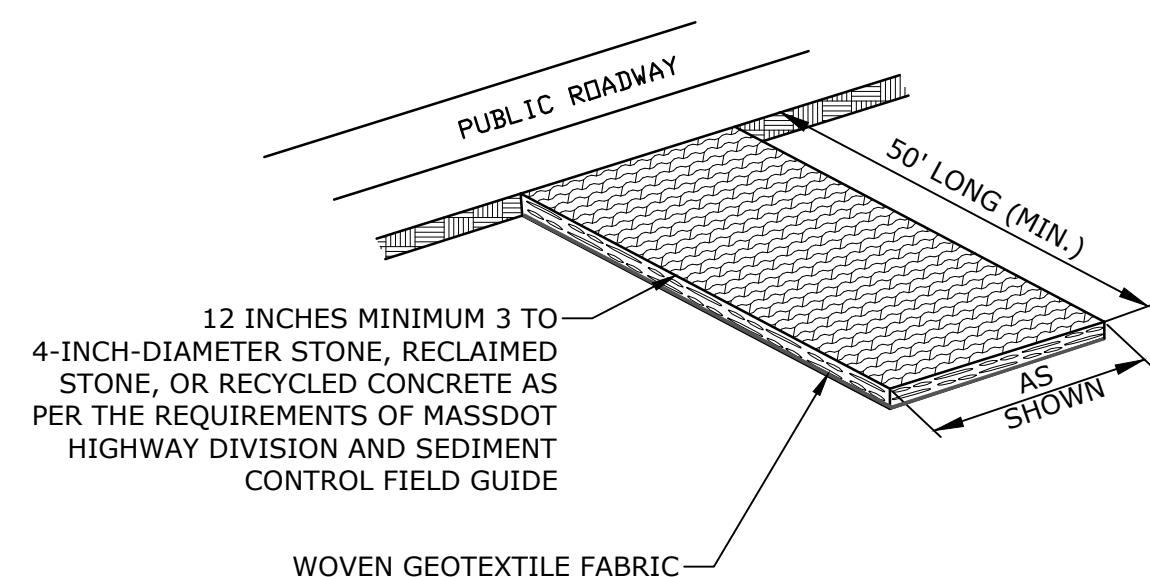

STABILIZED CONSTRUCTION ENTRANCE/EXIT
NO SCALE

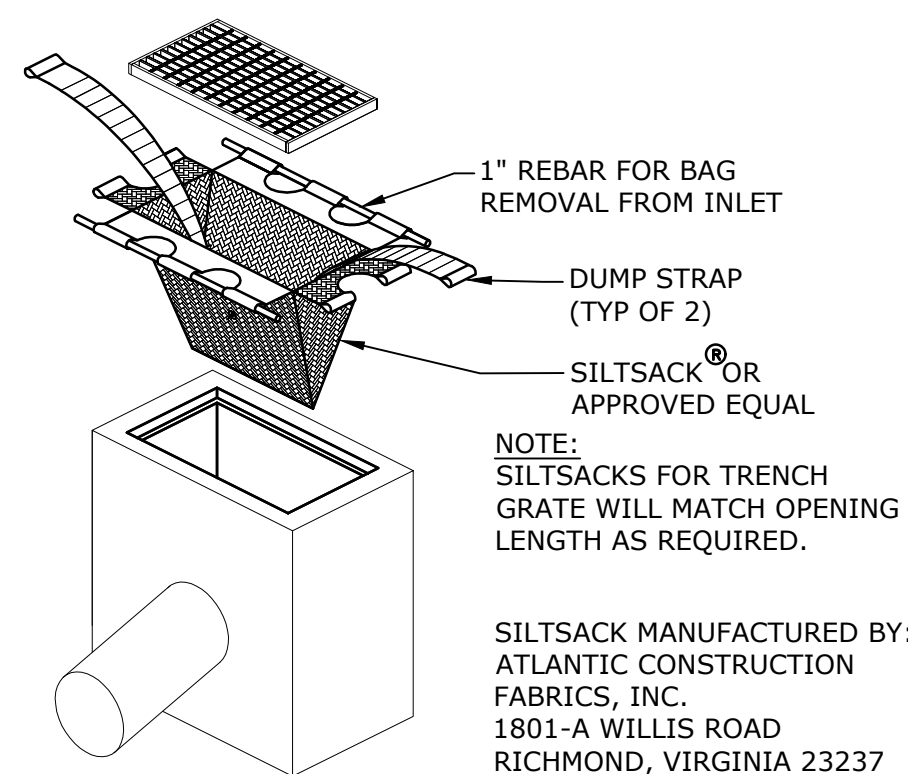

SILTSACK® INLET PROTECTION
NO SCALE

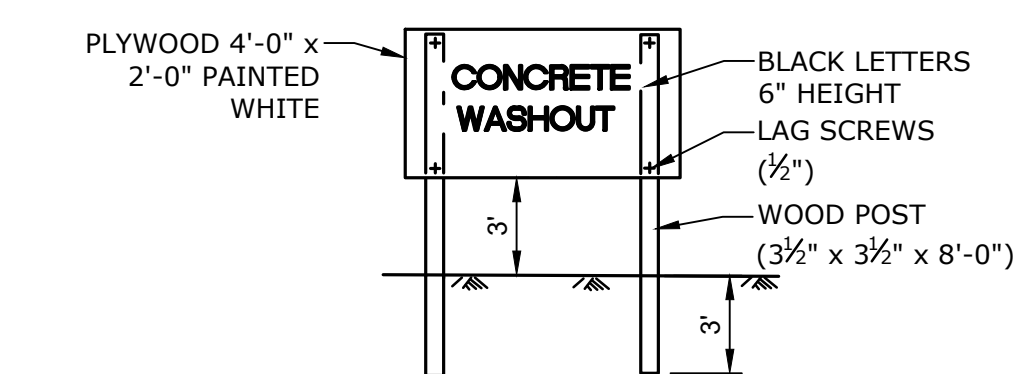
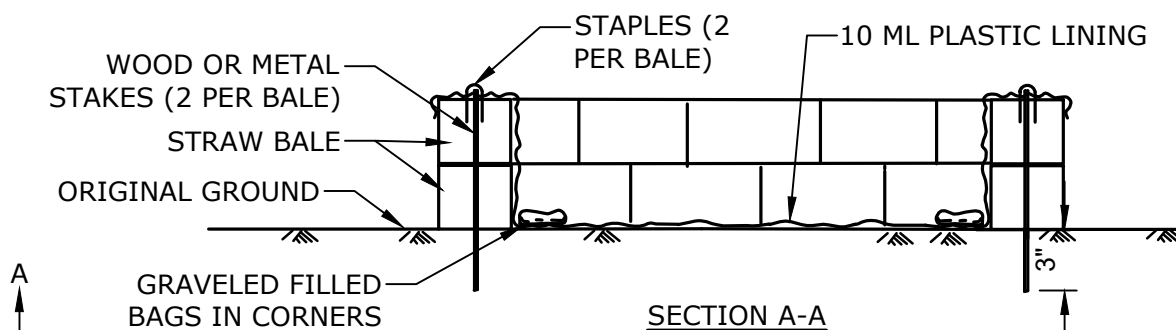
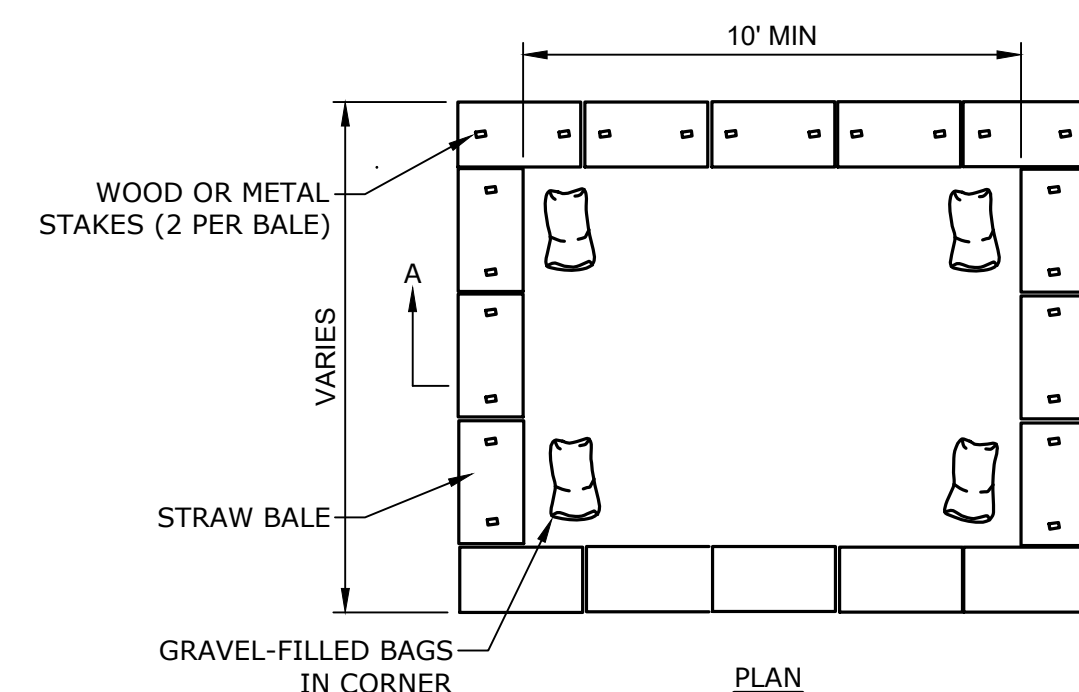

CONCRETE WASHOUT SIGN

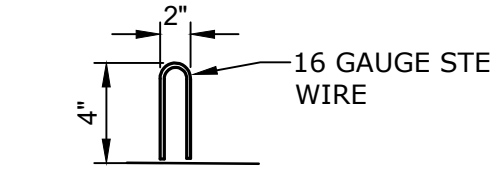

STAPLE DETAIL

NOTES

1. TEMPORARY CONCRETE WASHOUT FACILITIES SHOULD BE LOCATED A MINIMUM OF 50 FEET FROM STORM DRAIN INLETS, OPEN DRAINAGE FACILITIES, AND WATER COURSES. EACH FACILITY SHOULD BE LOCATED AWAY FROM CONSTRUCTION TRAFFIC OR ACCESS AREAS TO PREVENT DISTURBANCE OR TRACKING.
2. A SIGN SHOULD BE INSTALLED ADJACENT TO EACH WASHOUT FACILITY TO INFORM CONCRETE EQUIPMENT OPERATORS TO UTILIZE THE PROPER FACILITIES.
3. TEMPORARY CONCRETE WASHOUT FACILITIES SHOULD BE CONSTRUCTED ABOVE GRADE. TEMPORARY CONCRETE WASHOUT FACILITIES SHOULD BE CONSTRUCTED AND MAINTAINED IN SUFFICIENT QUANTITY AND SIZE TO CONTAIN ALL LIQUID AND CONCRETE WASTE GENERATED BY WASHOUT OPERATIONS.
4. TEMPORARY WASHOUT FACILITIES SHOULD HAVE A TEMPORARY PIT OR BERMED AREAS OF SUFFICIENT VOLUME TO COMPLETELY CONTAIN ALL LIQUID AND WASTE CONCRETE MATERIALS GENERATED DURING WASHOUT PROCEDURES.
5. WASHOUT OF CONCRETE TRUCKS SHOULD BE PERFORMED IN DESIGNATED AREAS ONLY.
6. ONLY CONCRETE FROM MIXER TRUCK CHUTES SHOULD BE WASHED INTO CONCRETE WASH OUT.
7. ONCE CONCRETE WASTES ARE WASHED INTO THE DESIGNATED AREA AND ALLOWED TO HARDEN, THE CONCRETE SHOULD BE BROKEN UP, REMOVED, AND DISPOSED OF PER SOLID WASTE MANAGEMENT STANDARDS. DISPOSE OF HARDENED CONCRETE ON A REGULAR BASIS.

CONCRETE WASHOUT AREA
NO SCALE

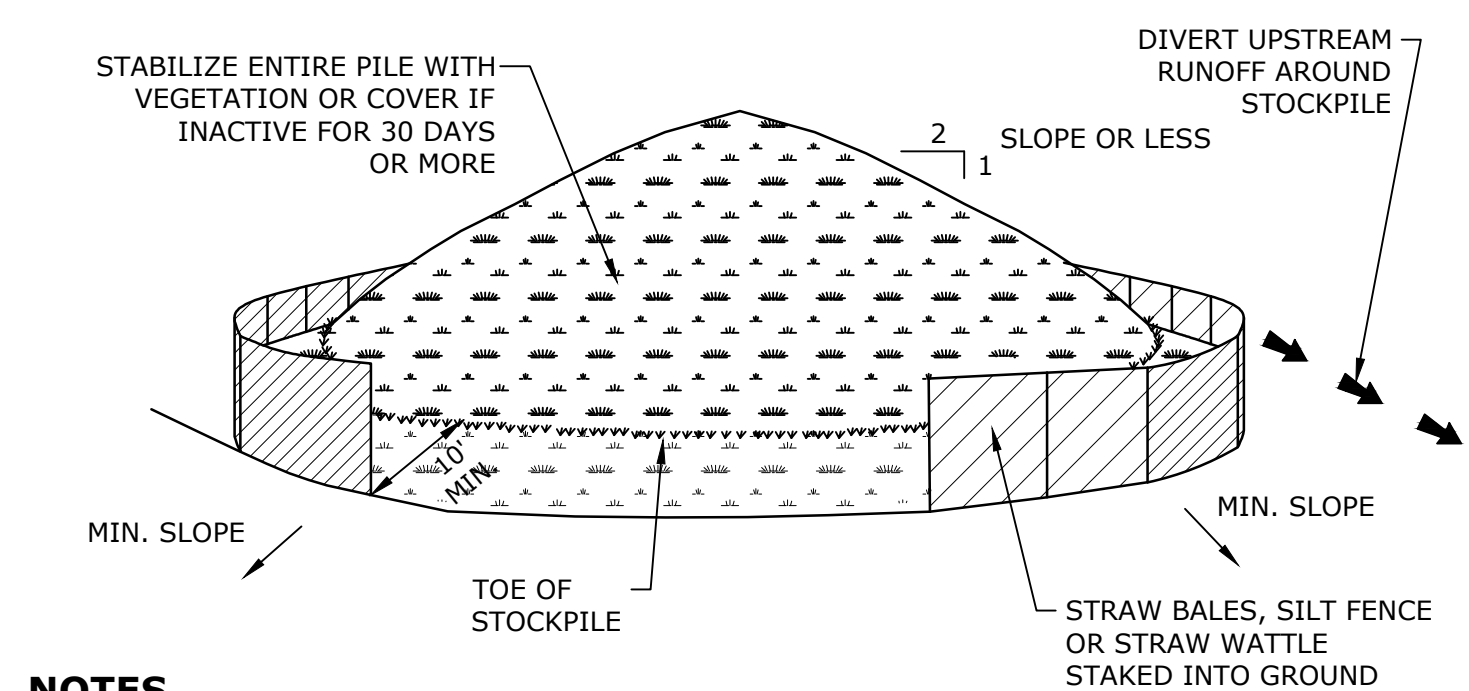

NOTES

1. AREA CHOSEN FOR STOCKPILING OPERATIONS SHALL BE DRY AND STABLE.
2. MAXIMUM SLOPE OF STOCKPILE SHALL BE 2H:1V.
3. UPON COMPLETION OF SOIL STOCKPILING, EACH PILE SHALL BE SURROUNDED WITH STRAW WATTLES, THEN STABILIZED WITH VEGETATION OR COVERED.

SOIL STOCKPILING
NO SCALE

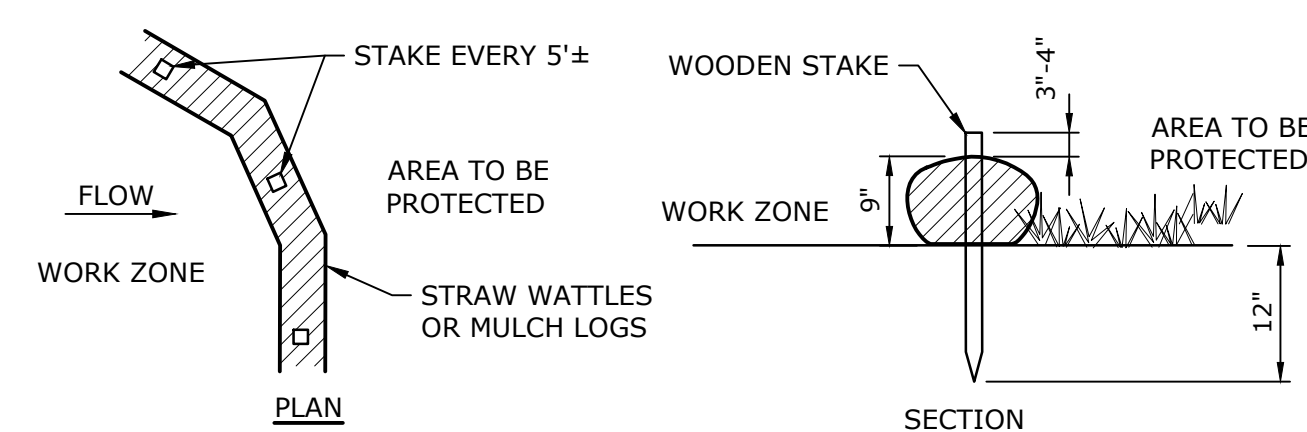

EROSION CONTROL BARRIERS
NO SCALE

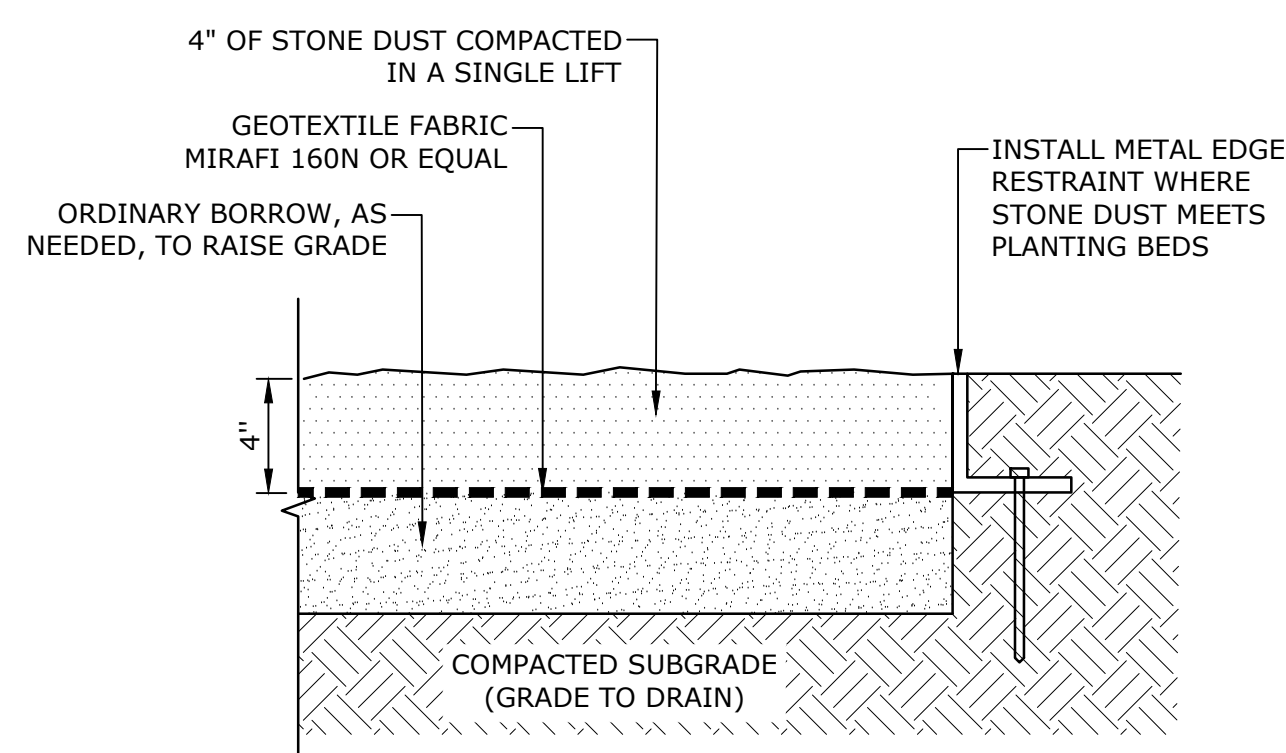

STONE DUST GRADATION REQUIREMENTS	
SIEVE SIZE DESIGNATION	PERCENT PASSING BY WEIGHT
1/4 INCH	100
#10	55 - 75
#40	20 - 40
#200	7 - 15

NOTES

1. STONE DUST WILL BE ACCEPTED ON THE BASIS OF MAGNESIUM SULFATE SOUNDNESS LOSS AFTER 4 CYCLES OF 20 PERCENT OR LESS.
2. STONE DUST MATERIAL WILL HAVE A PLASTIC INDEX OF THE MATERIAL PASSING THE #40 MESH SIEVE OF NOT GREATER THAN 5.0.

STONE DUST
NO SCALE

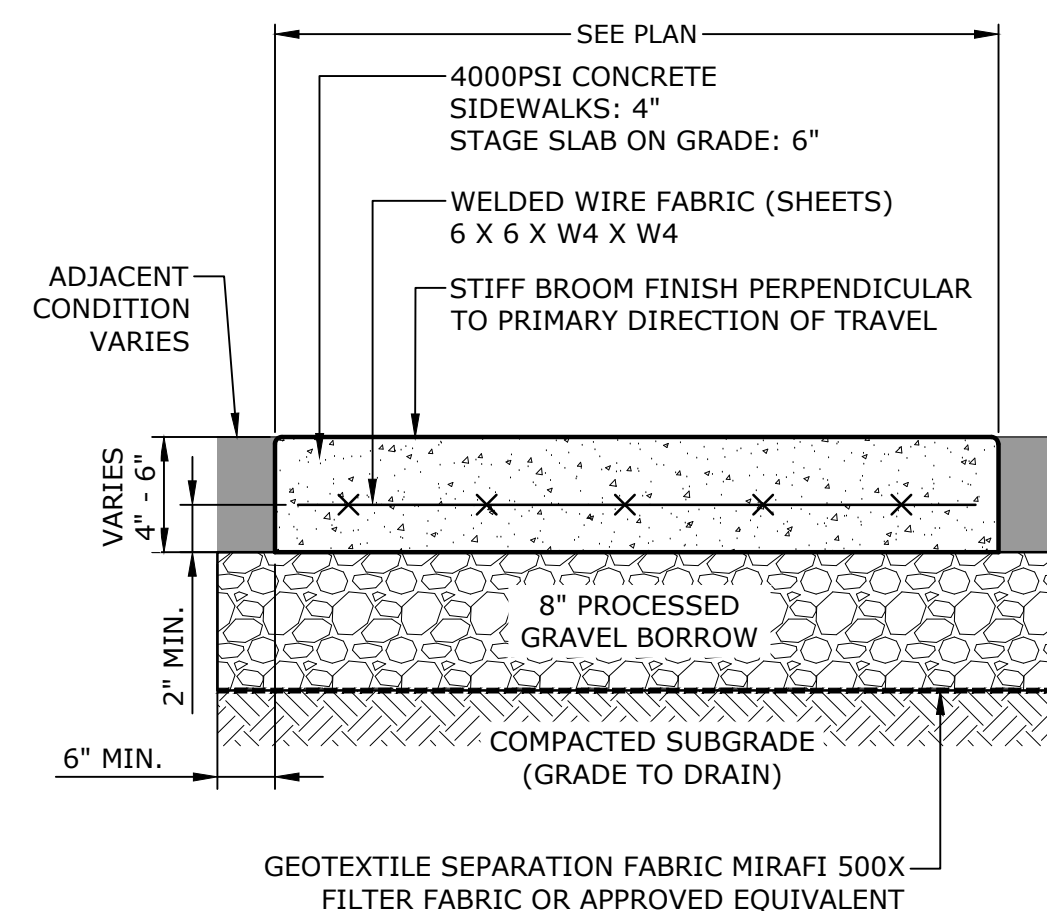

NOTES

1. CROSS SLOPE SHALL NOT EXCEED 1.5% LONGITUDINAL SLOPE SHALL NOT EXCEED 4.5%.
2. CONTROL JOINTS - 5' MAX. SPACING OR AS SHOWN ON PLANS.
3. EXPANSION JOINTS - 20' MAX. SPACING OR AS SHOWN ON PLANS.
4. CHEMICAL CURING AND ANTI-SPALLING COMPOUND (SEALER) ASTM C-309, TYPE 1D, CLASS B WITH MINIMUM 18% TOTAL SOLIDS CONTENT. NO THINNING OF MATERIAL ALLOWED. APPLY (2) COATS OF APPROVED SEALER TO TOP OF CONCRETE.

CEMENT CONCRETE SIDEWALK
NO SCALE

ISSUED FOR BIDDING

Maki Park Project

Department of Community Development and Planning

Gardner, MA

MARK	DATE	DESCRIPTION
0	5/2/2023	ISSUED FOR BIDDING
DATE:	05/2023	
PROJECT NO:	G0384-80	
FILE:	G0384-80 C-500-DETL arch.dwg	
DRAWN BY:	JDG	
CHECKED BY:	MPW	
APPROVED BY:	JPV	

SITE DETAILS - 1

SCALE: AS SHOWN

C-501
SHEET 7 OF 13

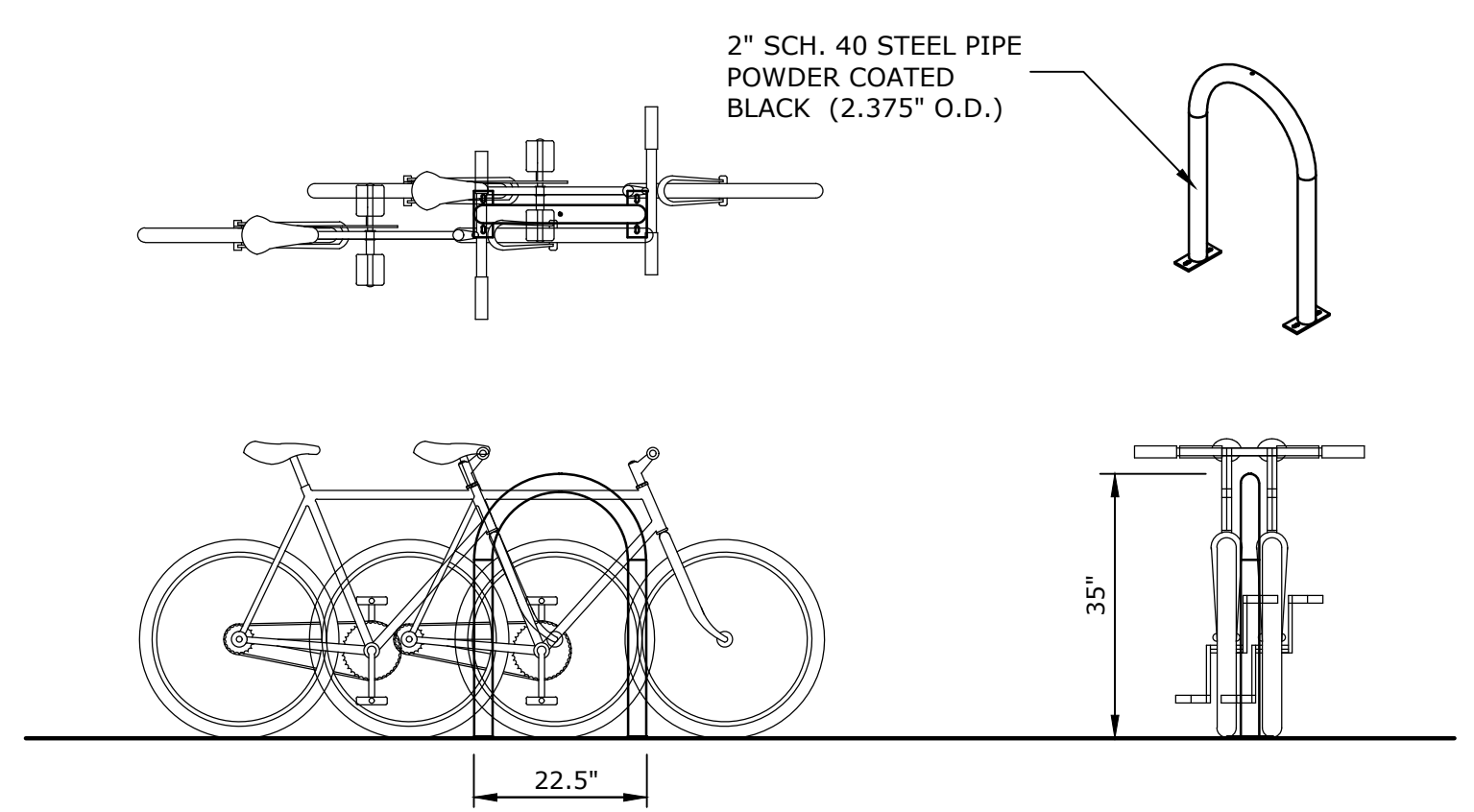

TYPICAL BIKE RACK
NO SCALE

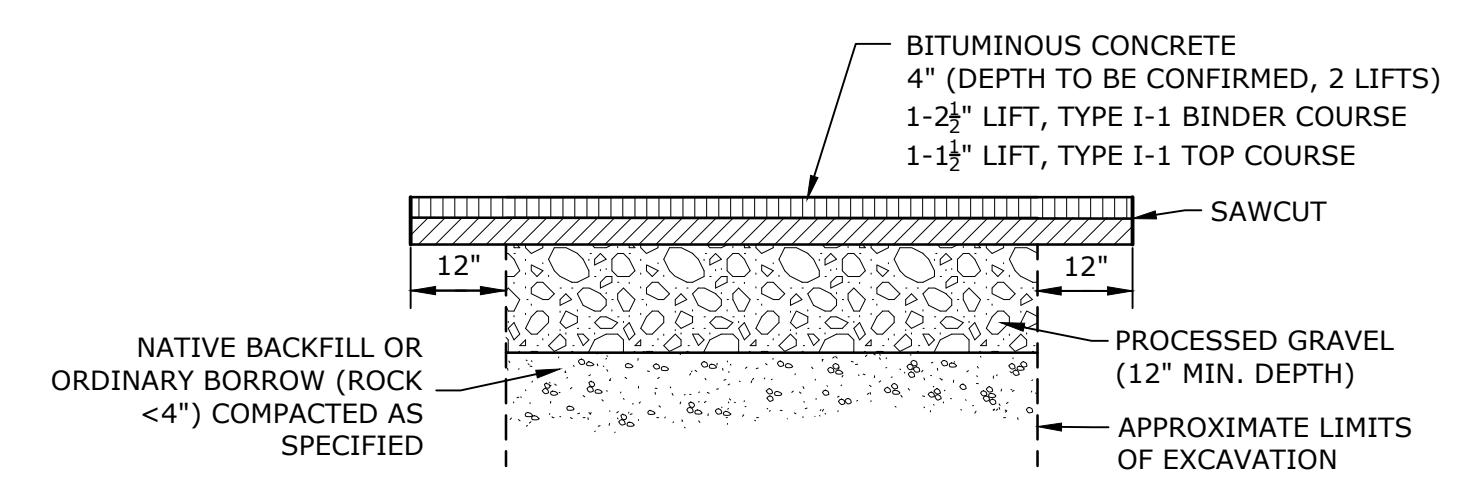

- NOTES:**
1. ANY ROUGH OR DAMAGED TRENCH EDGES SHALL BE SAWCUT CLEAN AND REPAVED.
 2. PROVIDE ALL REQUIRED BACKUP MATERIAL (GRAVEL OR LOAM AND SEED) ALONG THE EDGES OF THE COMPLETED TOP COURSE.

PAVEMENT REPAIR DETAIL
NO SCALE

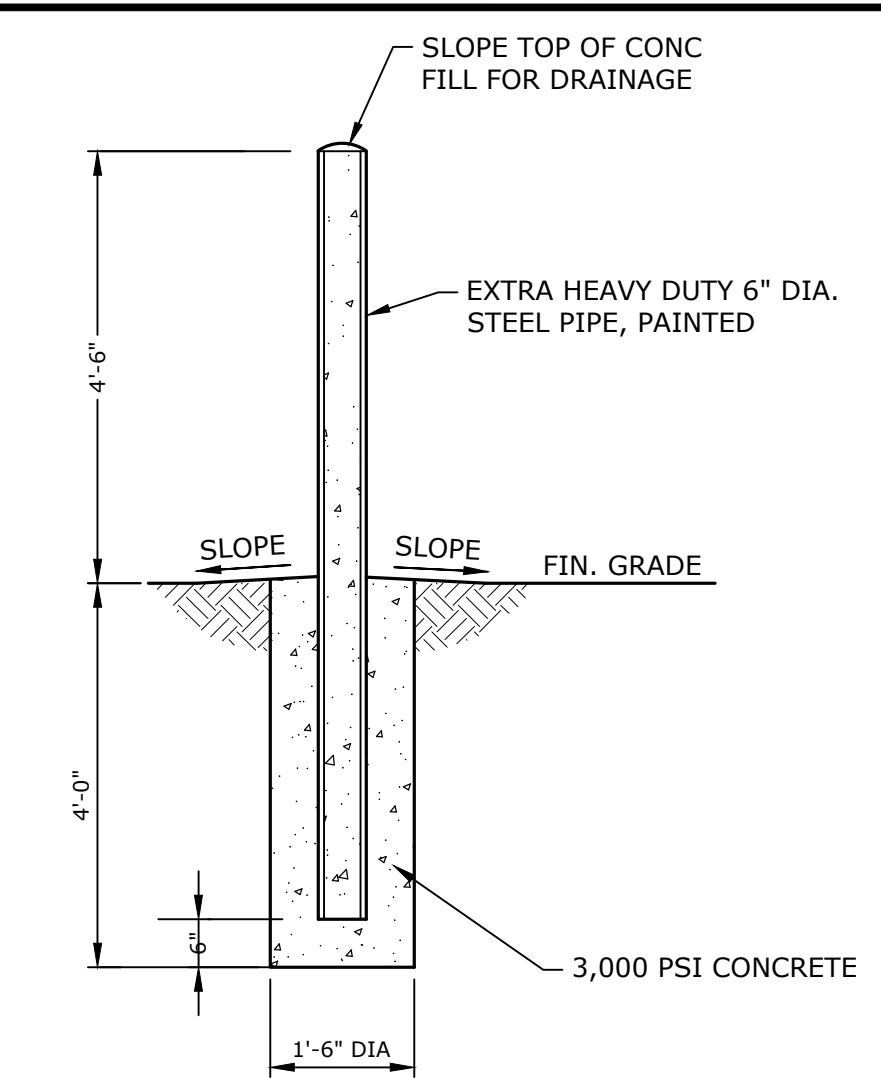

6" DIAMETER STEEL BOLLARD
NO SCALE

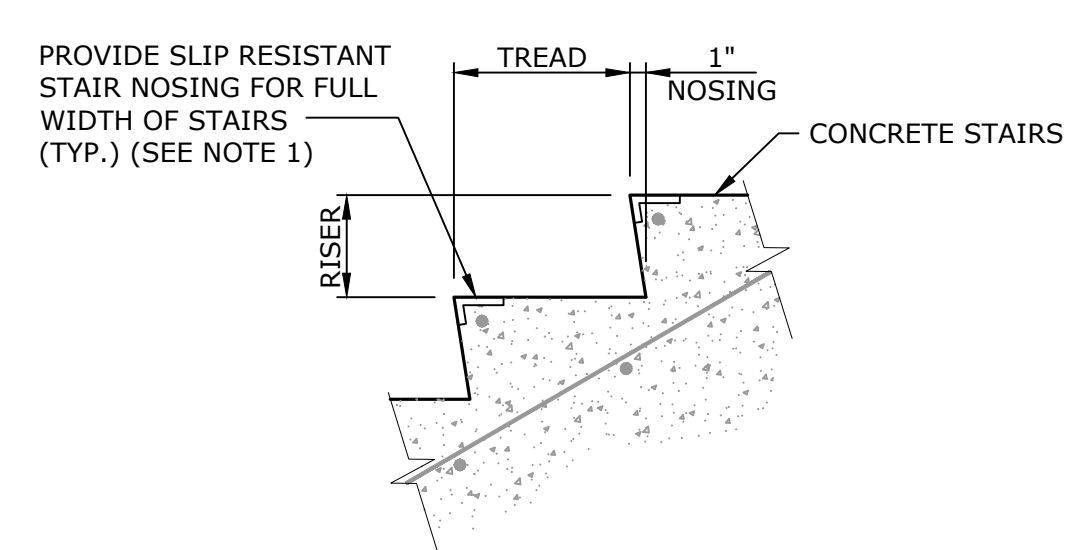

- NOTES:**
1. STAIR NOSINGS SHALL BE AMERICAN SAFETY TREAD STYLE 801 ALUMACAST OR EQUAL.

CONCRETE STEP TREAD DETAIL
NO SCALE

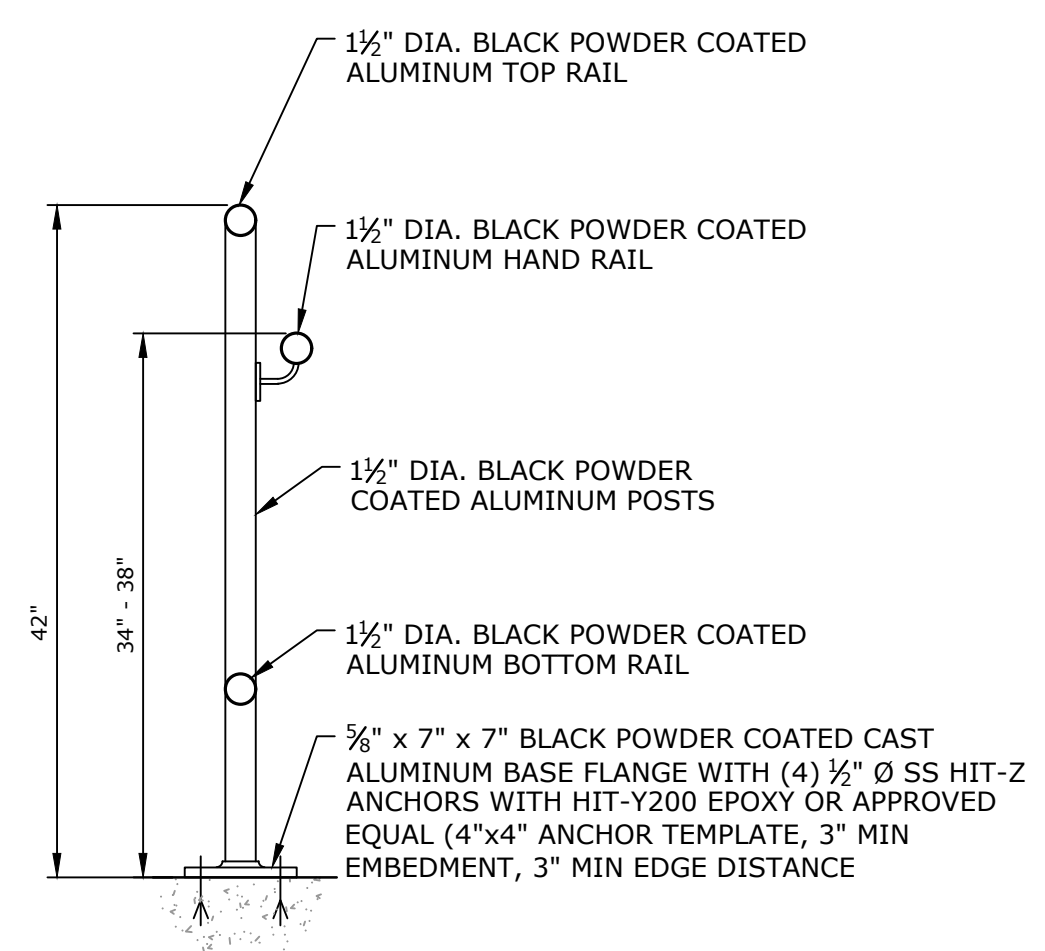

STAIR HANDRAIL DETAIL
NO SCALE

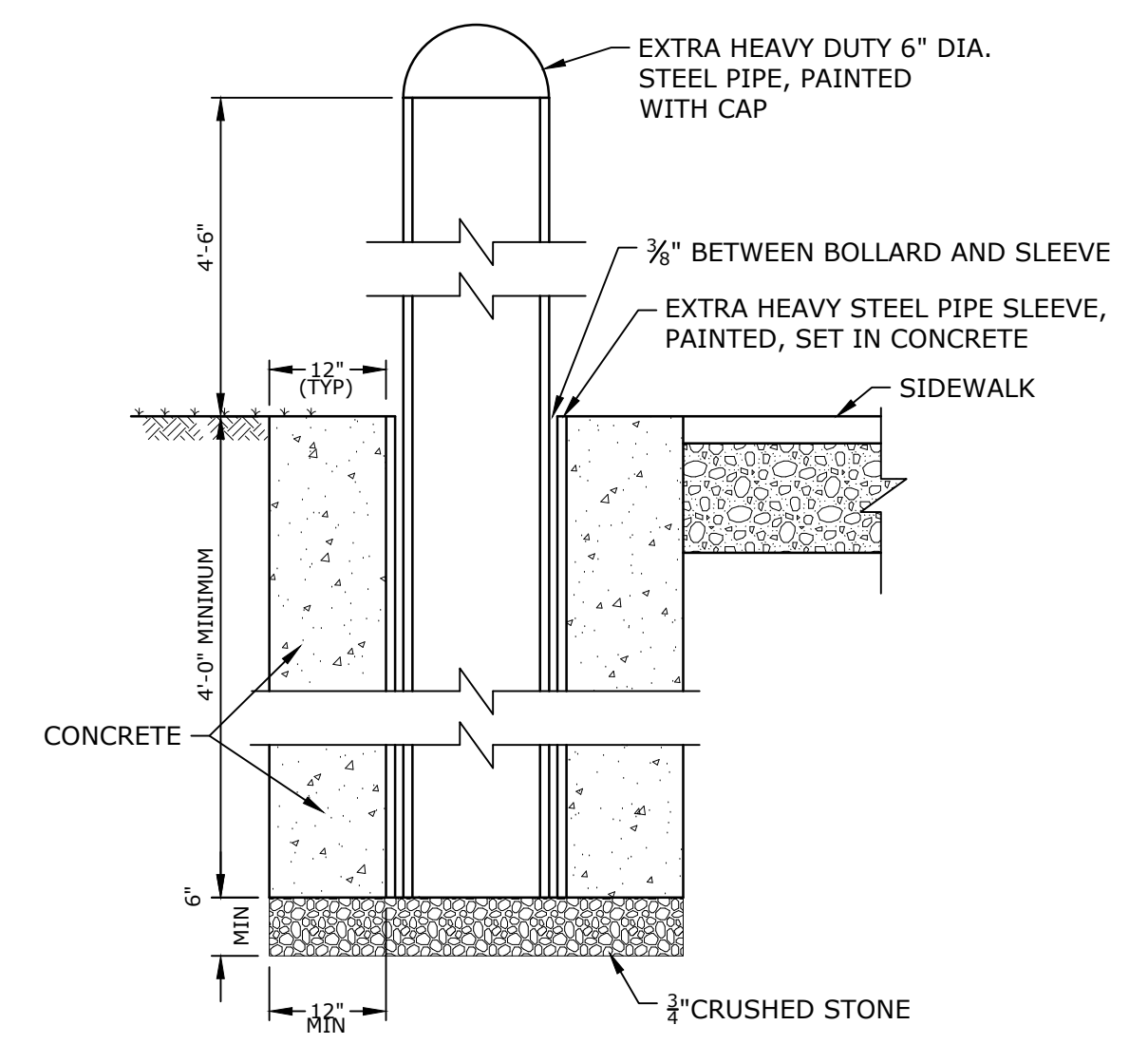

- NOTES:**
1. PROVIDE INTERNAL LOCKING HARDWARE
 2. PROVIDE LOCKING FILLER PIECE TO INSERT INTO EMPTY HOLE WHEN BOLLARD IS REMOVED

REMOVABLE BOLLARD DETAIL
NO SCALE

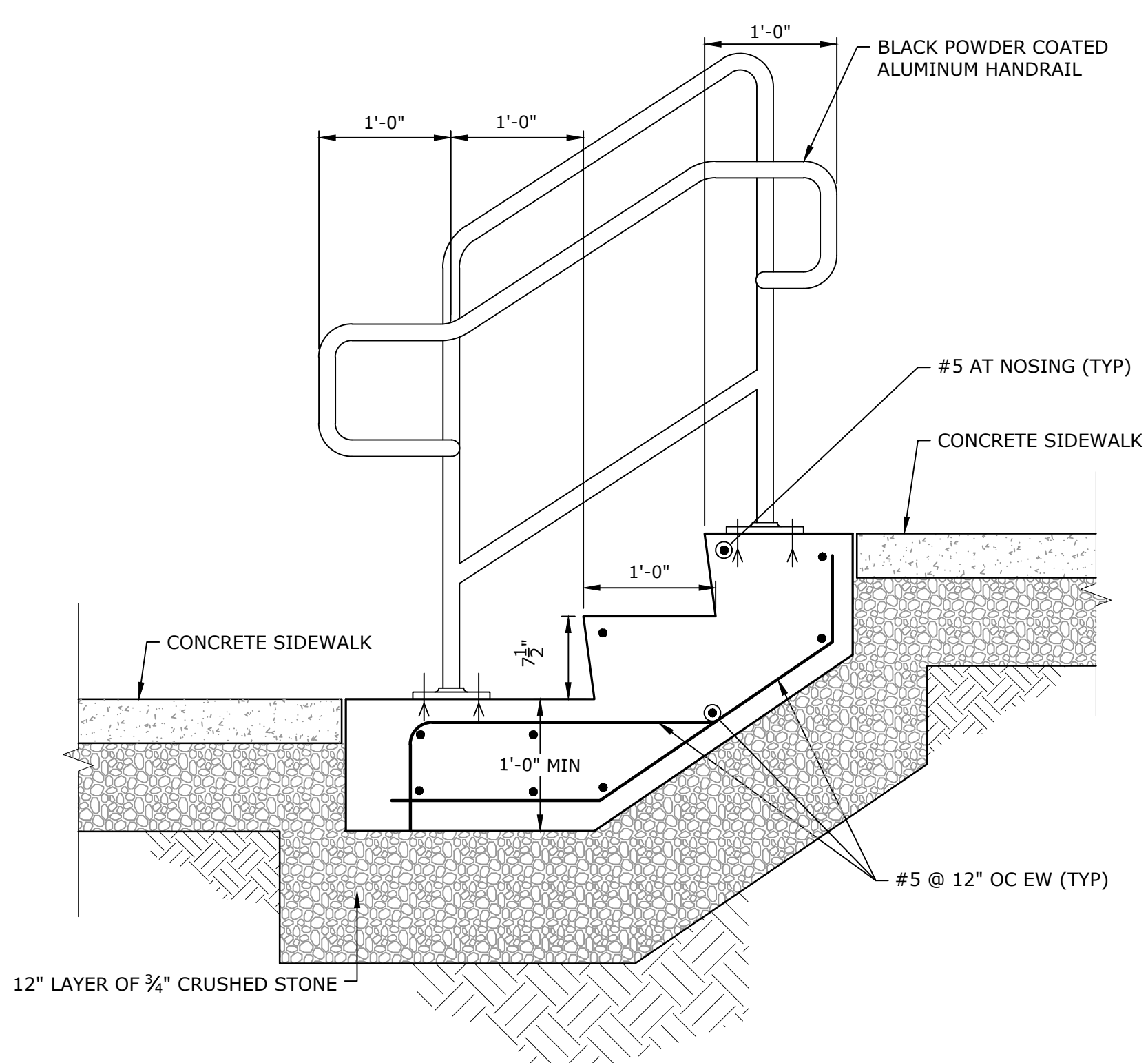

- NOTES:**
1. SEE PLAN FOR NUMBER OF STAIR TREADS.

CONCRETE STEPS AND ALUMINUM HANDRAIL
1" = 1'-0"

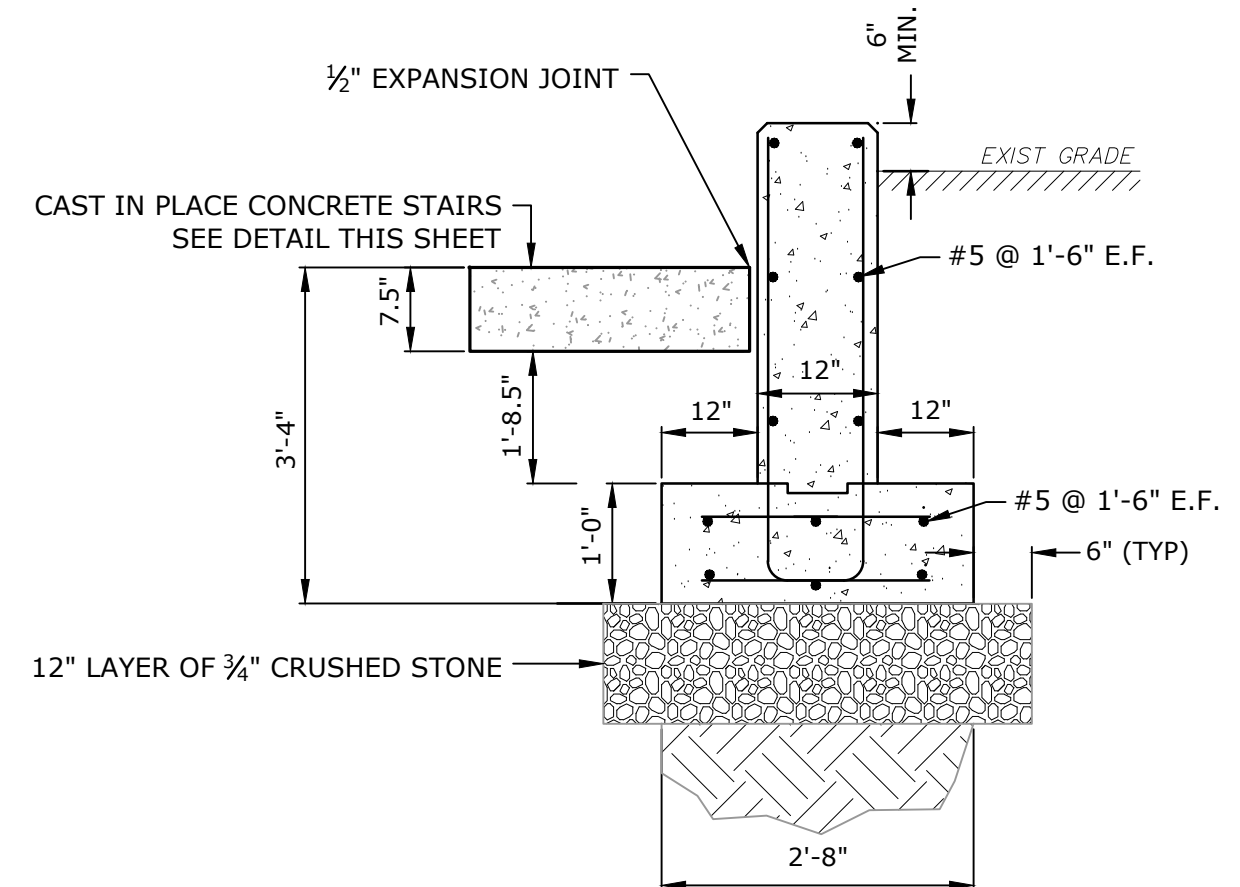

CAST-IN-PLACE CONCRETE RETAINING WALL
NO SCALE

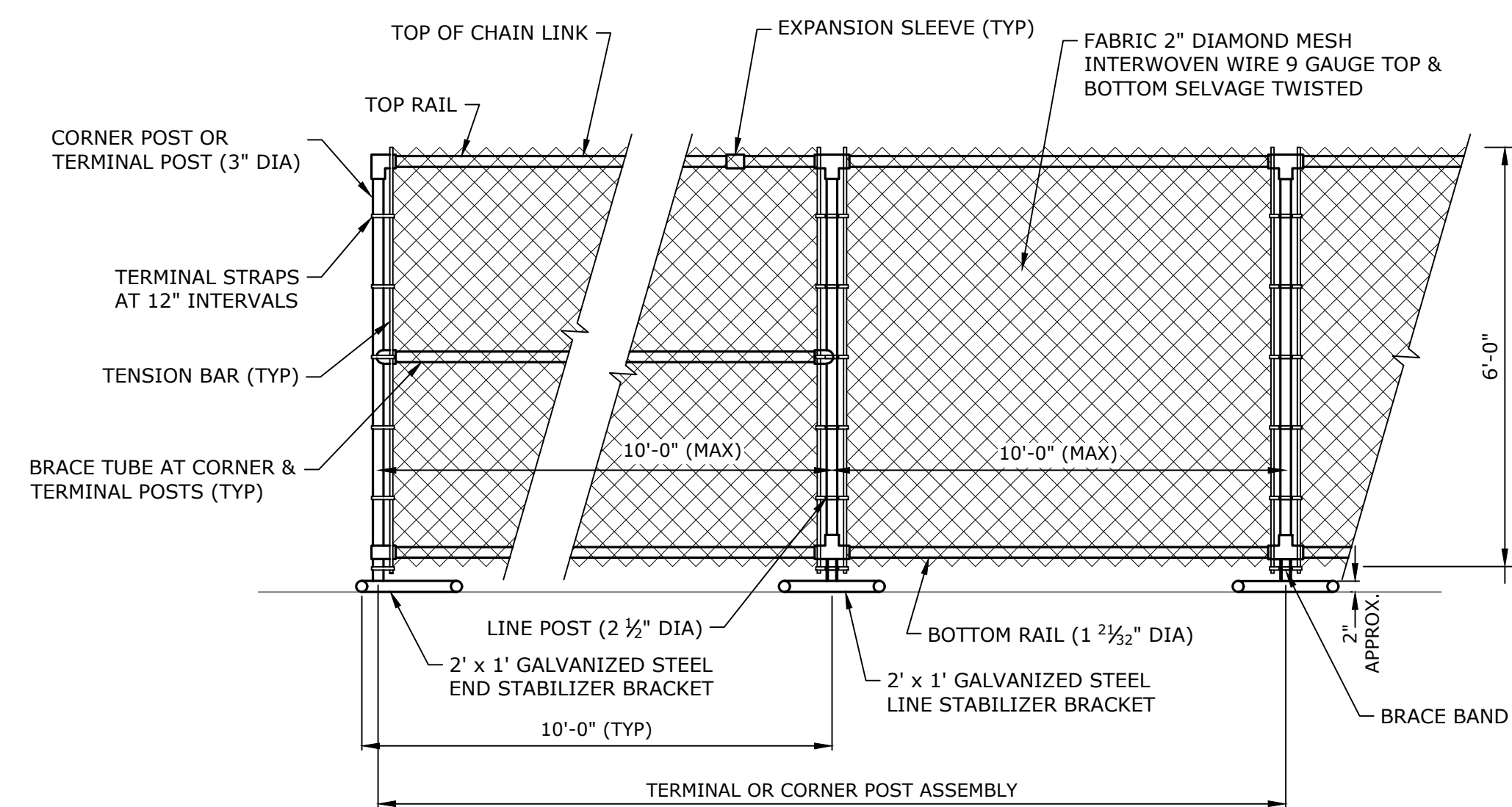

6' TEMPORARY CHAIN LINK FENCE
NO SCALE

ISSUED FOR BIDDING

Maki Park Project

Department of
Community
Development
and Planning

Gardner, MA

MARK	DATE	DESCRIPTION
0	5/2/2023	ISSUED FOR BIDDING
PROJECT NO:	G0384-80	
DATE:	05/2023	
FILE:	G0384-80 C-500-DETL arch.dwg	
DRAWN BY:	JDG	
CHECKED BY:	MPW	
APPROVED BY:	JPV	

SITE DETAILS - 3

SCALE: AS SHOWN

C-503
SHEET 9 OF 13

Last Saved: 5/2/2023 1:40pm By: ABS
 Plotted On: May 02, 2023 1:40pm
 Tighe & Bond 1135 Gardner St - Maki Park Drawings\AutoCAD\Sheet\G0384-80 C-500-DETL arch.dwg

RACEWAYS AND WIRING

- > HOMERUN TO EQUIPMENT, RECEPTACLE OR LIGHTING.
- CONDUIT, CONCEALED IN CONSTRUCTION IN FINISHED AREAS, EXPOSED IN UNFINISHED AREAS
- E ————— UNDERGROUND CONDUIT (SHADING INDICATES CONCRETE ENCASED)

NOTES:

1. GREEN GROUND CONDUCTOR NOT INDICATED BUT SHALL BE INCLUDED IN EACH RACEWAY. SIZE SHALL BE #12AWG UNLESS INDICATED OTHERWISE.
2. HOMERUNS TO PANELBOARDS SHALL HAVE A MAXIMUM OF THREE (3) PHASE CONDUCTORS (ONE PER PHASE), (3) NEUTRALS AND (3) GROUND CONDUCTORS IN EACH CONDUIT.

MISCELLANEOUS

- LC LIGHTING LOAD CENTER ENCLOSURE
- HH HANDHOLE

GENERAL SITE NOTES

1. ALL EXCAVATION, TRENCHING, BACK FILL AND COMPACTION OF DUCT BANKS, LIGHT LOADING CENTER PADS, BY THE GC.
2. WHERE ROUTING IS SPECIFICALLY INDICATED, CONDUITS SHALL BE ROUTED AS INDICATED ON THE DRAWING. NO EXCEPTION WITHOUT PRIOR WRITTEN PERMISSION FROM THE PROJECT ELECTRICAL ENGINEER.
3. ALL CONCRETE WORK SHALL BE BY THE GC.

ABBREVIATIONS

- # WIRE SIZE OR IDENTIFICATION NUMBER
- AFF ABOVE FINISHED FLOOR
- C CONDUIT
- CB CIRCUIT BREAKER
- CIR, CKT CIRCUIT
- EC ELECTRICAL CONTRACTOR
- G GROUND
- GC GENERAL CONTRACTOR
- GFI, GFCI GROUND FAULT CIRCUIT INTERRUPTER
- HDPC HIGH DENSITY PLASTIC COMPOSITE
- PVC POLYVINYL CHLORIDE
- RGS RIGID GALVANIZED STEEL CONDUIT
- SCH 40 SCHEDULE 40 PVC CONDUIT
- SW SWITCH
- TYP TYPICAL
- UG UNDERGROUND
- WP WEATHER PROOF

RECEPTACLES

- MOUNTED AT 18" AFF UNLESS OTHERWISE NOTED.
- NUMBERS/LETTERS SHOWN BESIDE RECEPTACLES SHALL INDICATED THE FOLLOWING:
 - "GFI" INDICATES INTEGRAL GROUND FAULT INTERRUPTER.
 - "2" (NUMBER OR PANELBOARD NAME AND NUMBER) INDICATES POWER CIRCUIT NUMBER.
 - "WP" INDICATES WATERPROOF.
-  DUPLEX RECEPTACLE.

ISSUED FOR BIDDING

Maki Park Project

Department of
Community
Development
and Planning

Gardner, MA

0	5/2/2023	ISSUED FOR BIDDING
MARK	DATE	DESCRIPTION
PROJECT NO:		G0384-80
DATE:		05/2023
FILE: G0384-80 E-001 LEGEND.dwg		
DRAWN BY:		AJP
CHECKED BY:		AL, MJR
APPROVED BY:		JPV

ELECTRICAL NOTES, LEGEND & ABBREVIATIONS

SCALE: NO SCALE

E-001
SHEET 10 OF 13

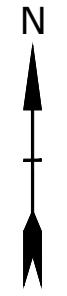

KEY NOTES:

- 1 PROVIDE (2) 2" PVC SCHEDULE 40 CONDUIT STUBBED INTO HANDHOLE WITH PULL STRINGS FOR FUTURE USE. REFER TO C-C UNDERGROUND CONDUIT DETAILS ON SHEET E-501.
- 2 PROVIDE (2) 2" PVC SCHEDULE 40 CONDUITS STUBBED INTO HANDHOLE WITH PULL STRINGS FOR FUTURE EV CHARGING STATIONS.
- 3 ALL STAGE ZONE RECEPTACLES SHALL BE SURFACE-MOUNTED AGAINST THE CONCRETE WALL (TYP). ELECTRICAL CONTRACTOR TO COORDINATE WIREWAY INSTALLATION AND MOUNTING PRIOR TO FINAL INSTALLATION.
- 4 REFER TO INCOMING SERVICE-UTILITY POLE TO LIGHTING LOAD CENTER (LC) DETAIL ON SHEET E-502 FOR ADDITIONAL INFORMATION.
- 5 LIGHTING LOAD CENTER (LC). REFER TO LIGHTING LOADCENTER (LC) DETAIL ON SHEET E-501 FOR ADDITIONAL INFORMATION.
- 6 UNDERGROUND CONDUIT. SEE DETAIL ON SHEET E-501 FOR ADDITIONAL INFORMATION.
- 7 SECONDARY SERVICE-ENTRANCE WIRING BY ELECTRICAL CONTRACTOR. 3#3/0 IN 2" RGS CONDUIT

PID: M22-5-8
20 GRAHAM ST
N/F QUEST MANAGEMENT GROUP LLC
BOOK/PAGE: 66416/176

PID: M22-5-10
GRAHAM ST
N/F CITY OF GARDNER
BOOK/PAGE: 7581/37

PID: M22-5-11
ON PARKER ST
N/F CITY OF GARDNER
BOOK/PAGE: 8434/0283

PID: M22-4-70
WEST STREET LOT
N/F CITY OF GARDNER
BOOK/PAGE: NO REF.

BENCHMARK:
BMK-B X-CUT BOMO
ELEV: 1084.39'

TOP OF CONCRETE WALL ELEVATIONS

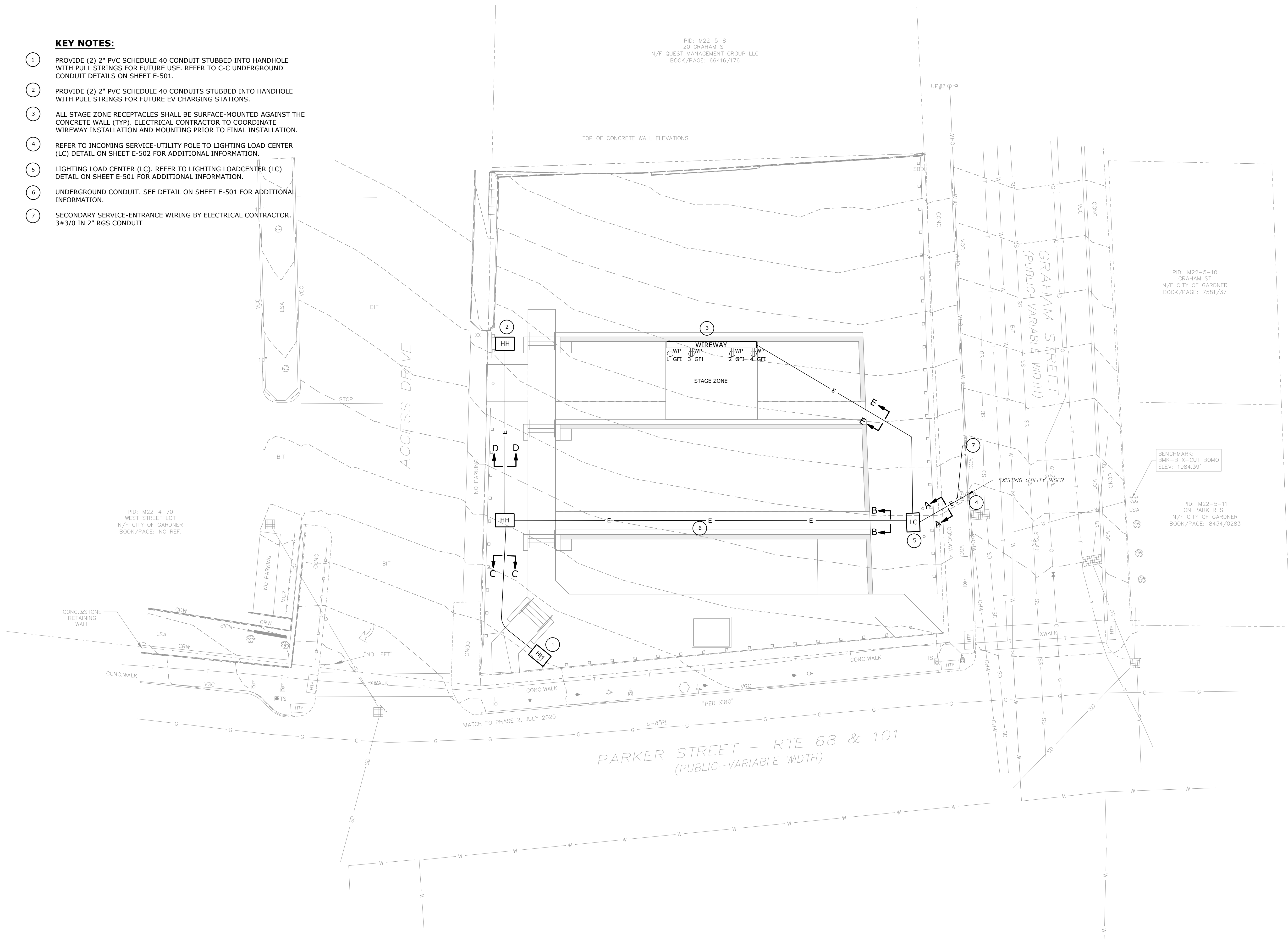

ISSUED FOR BIDDING

Maki Park Project

Department of
Community
Development
and Planning

Gardner, MA

MARK	DATE	DESCRIPTION
0	5/2/2023	ISSUED FOR BIDDING

PROJECT NO: G0384-80

DATE: 05/2023

FILE: G0384-80 E-100-PLANS.dwg

DRAWN BY: AJP

CHECKED BY: AL, MJR

APPROVED BY: JPV

ELECTRICAL SITE PLAN

SCALE: 1" = 10'

E-100
SHEET 11 OF 13

Last Saved: 4/26/2023 1:31pm By: APardave
 Plotted On: May 02, 2023 1:31pm
 Tighe & Bond: \\tighetbond.com\data\projects\G0384-Gardner\T80 - Maki Park\Drawings\AutoCAD\Sheet\G0384-80 E-100-PLANS.dwg

ISSUED FOR BIDDING

Maki Park Project

Department of
Community
Development
and Planning

Gardner, MA

0	5/2/2023	ISSUED FOR BIDDING
MARK	DATE	DESCRIPTION
PROJECT NO:	G0384-80	
DATE:	05/2023	
FILE:	G0384-80 E-501 Details.dwg	
DRAWN BY:	AJP	
CHECKED BY:	AL, MJR	
APPROVED BY:	JPV	

ELECTICAL DETAILS - 1

SCALE: NO SCALE

E-501
SHEET 12 OF 13

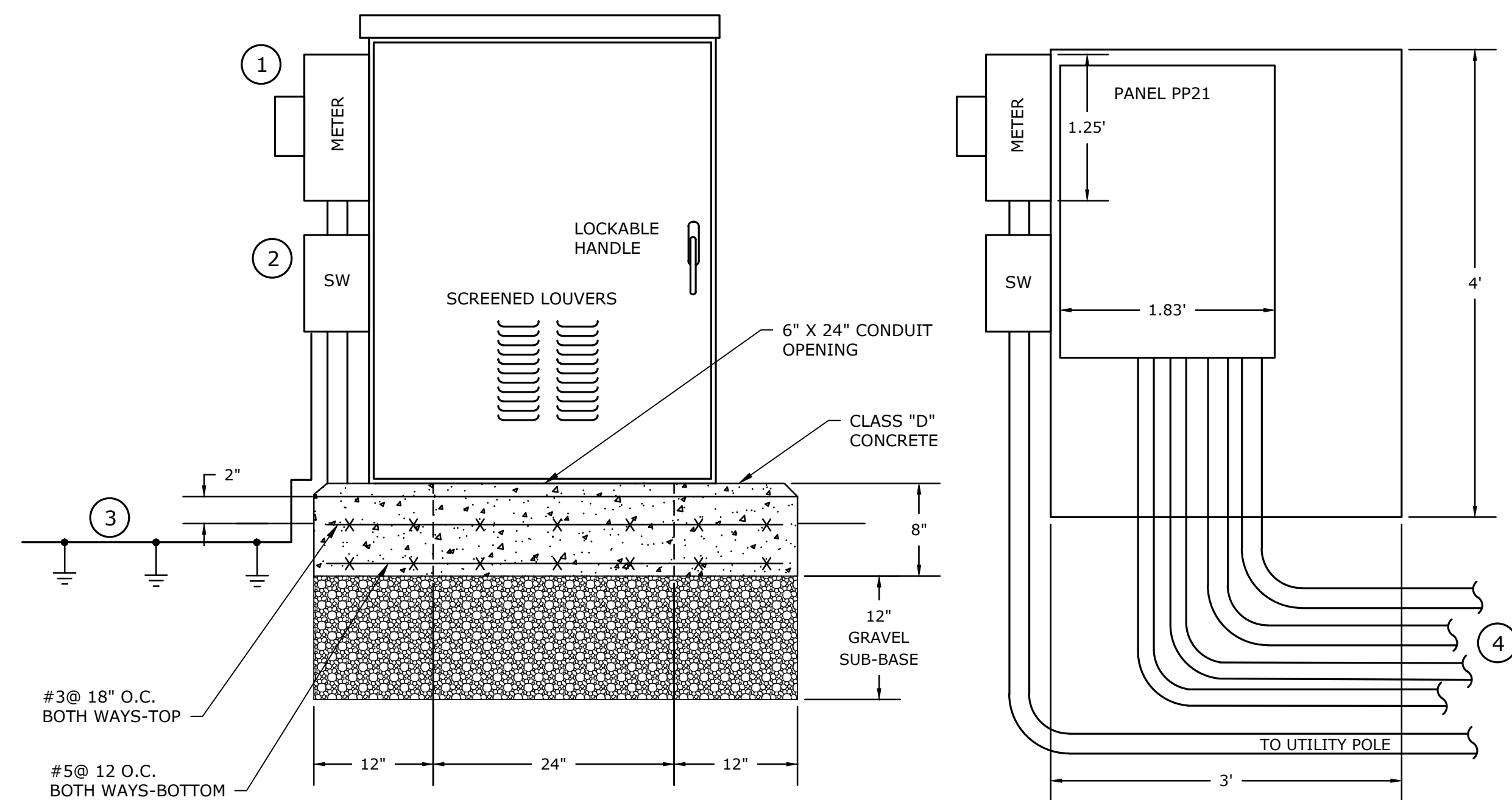

LIGHTING LOAD CENTER (LC)
NO SCALE

NOTES - LIGHTING LOAD CENTER:

1. ENCLOSURE SHALL BE NEMA 3R ALUMINUM CONSTRUCTION. FINISH SHALL BE UNPAINTED ALUMINUM. SUBMIT ENCLOSURE EQUIPMENT (PANEL, METER SOCKET, ETC LAYOUT FOR APPROVAL BY ENGINEER PRIOR TO INSTALLATION).

- ① PROVIDE CLASS 200 SOCKET FOR ELECTRIC METER. ELECTRIC METER TO BE PROVIDED BY UTILITY COMPANY.
- ② LOCKABLE 200A NEMA 3R FUSED DISCONNECT SWITCH SERVICE ENTRANCE RATED.
- ③ PROVIDE GROUNDING TRIAD AT SERVICE ENTRANCE RATED DISCONNECT SWITCH. SIZE OF GROUNDING ELECTRODE CONDUCTORS SHALL BE #2/0.
- ④ TO HANDHOLE VIA B-B UNDERGROUND CONDUIT

		VOLTAGE (L-L):	240	PHASE:	1	WIRE:	3	VA, L1	2,840	PANEL NO.	PP21		
		VOLTAGE (L-N):	120			VA, L2	2,880			LOCATION: Lighting Load Center (LC)			
		MAIN BUS:	200	AMPS						NOTES:			
		MAIN BREAKER:	200	A FRAME	200	A TRIP				MOUNTING: SURFACE KAIC: 22 TOTAL VA 5,720			
		INCOMING FEEDER SIZE: REFER TO ONE-LINE DIAGRAM											
WIRE SIZE	CONDUIT SIZE	DIRECTORY	VA LOAD				VA LOAD				CONDUIT SIZE	WIRE SIZE	
			L1	L2	CKT.	AMPS	AMPS	CKT.	L2	L1			DIRECTORY
2#10 & 1#12G	2"	STAGE ZONE REC 1	1,400		1	20	20	2	1,440		STAGE ZONE REC 2	2"	2#10 & 1#12G
2#10 & 1#12G	2"	STAGE ZONE REC 3		1,440	3	20	20	4		1,440	STAGE ZONE REC 4	2"	2#10 & 1#12G
-	-	FUTURE EV CHARGER 1			5	40	40	6			FUTURE EV CHARGER 2	-	-
-	-				7	40	40	8				-	-
-	-	FUTURE CONNECTIONS			9	20	20	10			FUTURE CONNECTIONS	-	-
-	-	FUTURE CONNECTIONS			11	20	20	12			FUTURE CONNECTIONS	-	-
-	-	FUTURE CONNECTIONS			13	20	20	14			FUTURE CONNECTIONS	-	-
-	-	FUTURE CONNECTIONS			15	20	20	16			FUTURE CONNECTIONS	-	-
-	-	FUTURE CONNECTIONS			17	20	20	18			SPARE	-	-
-	-	SPARE			19	20	20	20			SPARE	-	-
-	-	SPARE			21	20	20	22			SPARE	-	-
-	-	SPARE			23	20	20	24			SPARE	-	-
-	-	SPARE			25	20	20	26			SPARE	-	-
-	-	SPARE			27	20	20	28			SPARE	-	-
-	-	SPARE			29	20	20	30			SPARE	-	-
		SUBTOTAL	1,400	1,440	0			1,440	1,440	0	SUBTOTAL		

PP21 PANELBOARD SCHEDULE

NOTES:

1. THE ELECTRICAL CONTRACTOR SHALL NOT FEED MORE THAN (2) RECEPTACLE BRANCH CIRCUITS PER CONDUIT.

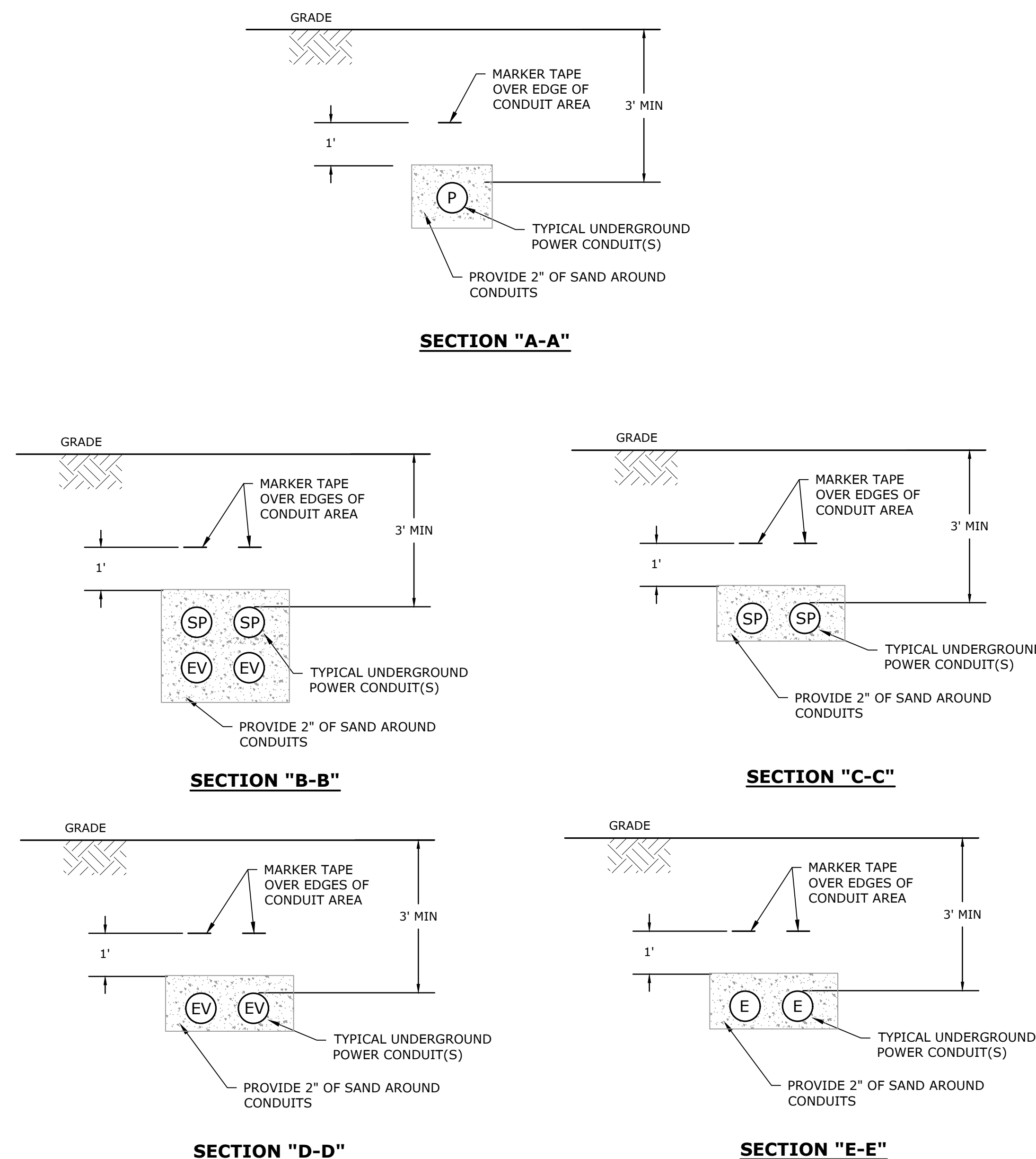

NOTES:

- 1. MAINTAIN 3" MIN SPACING BETWEEN ALL POWER CONDUITS
- 2. MAINTAIN MINIMUM 1' SEPARATION BETWEEN ALL POWER CONDUITS AND OTHER UNDERGROUND SYSTEMS.

- Ⓟ 2" RGS CONDUIT FOR INCOMING FEEDER
- ⓔ 2" SCH 40 PVC CONDUIT FOR RECEPTACLE WIRES
- ⓔⓋ 2" SCH 40 PVC CONDUIT FOR FUTURE EV CHARGERS
- ⓈⓅ SPARE 2" SCH 40 PVC CONDUIT

UNDERGROUND CONDUIT SECTIONS (DIRECT BURY)
NO SCALE

Last Saved: 4/26/2023 1:31pm By: AJP
 Plotted On: May 02, 2023 1:31pm By: AJP
 Tighe & Bond \\\globe.tigheandbond.com\data\projects\G0384-Gardner\T80 - Maki Park\Drawings\AutoCAD\Sheet\G0384-80 E-501 Details.dwg

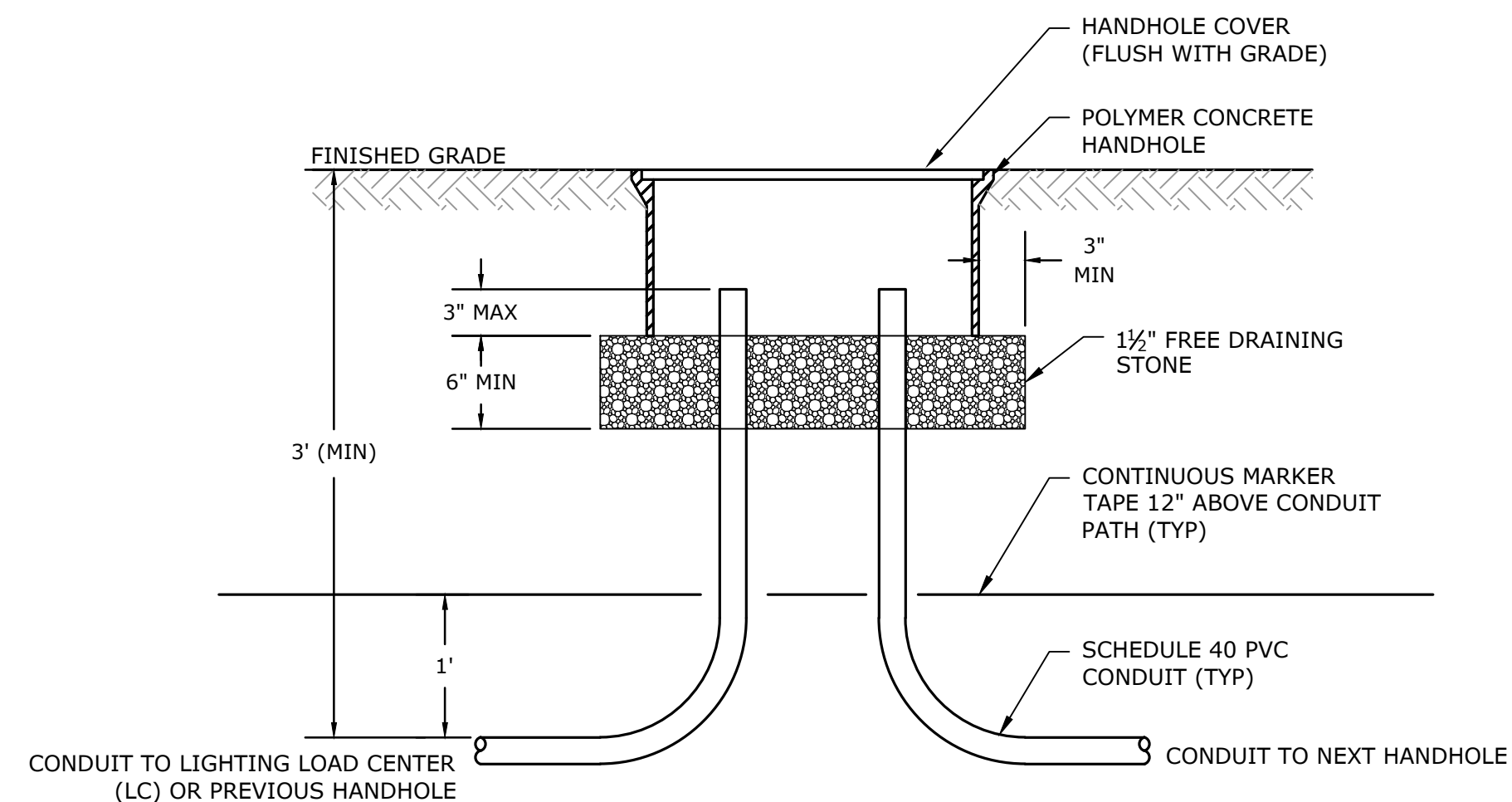

POWER HANDHOLE - 17"Wx30"Lx12" DEEP HDPC HANDHOLE WITH DUAL COVER LABELED "LOW VOLTAGE/LIGHTING"

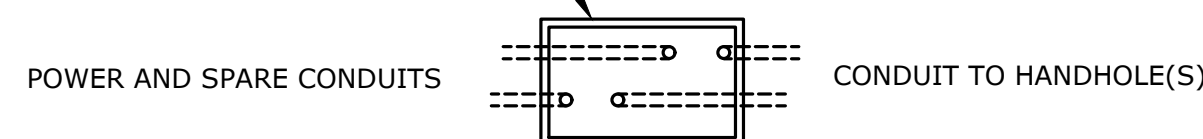

NOTES:

- COORDINATE WITH SITE ELECTRICAL PLANS. CONDUIT TYPES SHOWN ARE TYPICAL. PROVIDE CONDUIT ENTRIES AND QUANTITIES AS SHOWN ON SITE PLANS.
- SPLICE CONDUCTORS (INCLUDING GROUNDING CONDUCTORS) IN HANDHOLE WITH SILICONE FILLED CONNECTORS RATED FOR UNDERGROUND. USE IDEAL #30-066 OR EQUAL FOR #6 OR SMALLER SPLICES. USE ILSCO PDSS OR EQUAL UNDERGROUND RATED LUGS FOR LARGER SPLICES.

GROUND PROVISIONS FOR STEEL CONDUIT INSTALLATIONS

- INSTALL LISTED "U" BOLT WITHIN 6" FROM TOP OF STEEL CONDUIT.
- PROVIDE 30' OF GROUND WIRE PER NEC REQUIREMENTS.

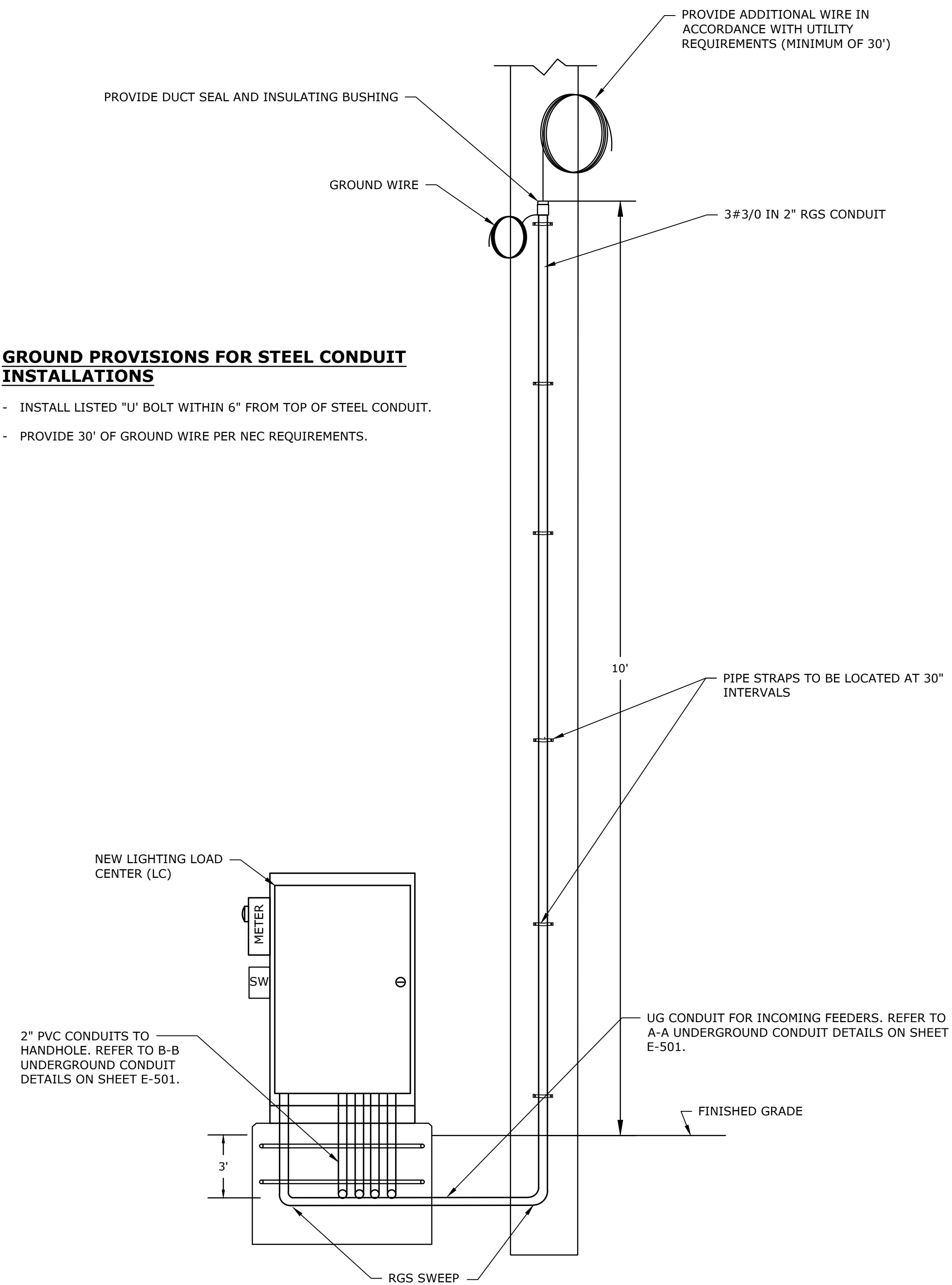

INCOMING SERVICE - UTILITY POLE TO LIGHTING LOAD CENTER (LC) DETAIL

NO SCALE

NOTES:

- COORDINATE ALL REQUIREMENTS WITH UTILITY COMPANY.
- PROVIDE SECONDARY SERVICE, COMPONENTS, CONDUCTORS, AND CONNECTIONS PER UTILITY STANDARDS.
- THE ELECTRICAL CONTRACTOR IS RESPONSIBLE FOR PROVIDING AND INSTALLING THE BOND CLAMPS AND THE TAP. THE UTILITY COMPANY WILL MAKE THE BOND CONNECTION FROM THE RISER BOND TAP TO THE GROUND SYSTEM POLE.
- DETAIL IS FOR REFERENCE ONLY - TO BE FINALIZED BY THE UTILITY COMPANY.

ISSUED FOR BIDDING

Maki Park Project

Department of
Community
Development
and Planning

Gardner, MA

MARK	DATE	DESCRIPTION
0	5/2/2023	ISSUED FOR BIDDING
PROJECT NO:		G0384-80
DATE:		05/2023
FILE: G0384-80 E-502 Details_B.dwg		
DRAWN BY:		AJP
CHECKED BY:		AL, MJR
APPROVED BY:		JPV

ELECTRICAL DETAILS - 2

SCALE: NO SCALE

E-502
SHEET 13 OF 13